

# NOTES

5



182

183

# SOCKETS AND ACCESSORIES



# 6

## IMPACT SOCKETS AND ACCESSORIES

184 - 194



## IMPACT SOCKETS SETS

195 - 198



## HAND SOCKETS AND ACCESSORIES

199 - 228



## HAND SOCKETS SETS

229 - 246



## BANLIN SOCKETS AND ACCESSORIES

247 - 252



## T-WRENCH

253 - 254



# IMPACT SOCKETS AND ACCESSORIES



## IMPACT SOCKETS AND ACCESSORIES

### 12732-51

#### Impact Sockets, 6-Point $\frac{3}{8}$ "

- DIN 3121 ISO 2725
- Chrome molybdenum alloy steel
- Phosphate sunk finish

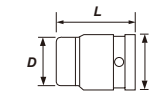

Size	D mm	D1 mm	L mm	Code	g
7	12.1	19	28	07	32
8	13.5	19	28	08	32
9	14.5	19	28	09	32
10	15.8	19	28	10	33
11	17	19	30	11	35
12	18.2	19	30	12	35
13	19.5	22	30	13	46
14	20.8	22	30	14	46
15	22	22	30	15	50
16	23.8	22	30	16	54
17	23.8	22	32	17	54
18	25.8	22	32	18	62
19	27.5	22	32	19	70
20	27.8	22	32	20	70
21	29.8	22	32	21	70
22	31.8	22	32	22	83

### 12732-62

#### Impact Deep Socket, 6-Point $\frac{3}{8}$ "

- DIN 3121 ISO 2725
- Chrome molybdenum alloy steel
- Phosphate sunk finish

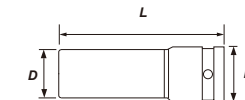

Size	D mm	D1 mm	L mm	Code	g
7	12.1	19	63	07	75
8	13.5	19	63	08	75
9	14.5	19	63	09	75
10	15.8	19	63	10	75
11	17	19	63	11	75
12	18.2	19	63	12	80
13	19.5	22	63	13	105
14	20.8	22	63	14	105
15	22	22	63	15	110
16	23.8	22	63	16	125
17	23.8	22	63	17	125
18	25.8	22	63	18	135
19	27.5	22	63	19	165
20	27.8	22	63	20	220
21	29.8	22	63	21	230
22	31.8	22	63	22	240

### 12732-81

#### Impact Universal Joint $\frac{3}{8}$ "

- DIN 3121 ISO 1174
- Chrome molybdenum alloy steel
- Phosphate sunk finish

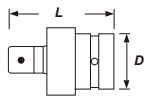

D mm	L mm	Code	g
24	48	54	105

### 12732-82

#### Impact Universal Joint (Pin Hole) $\frac{3}{8}$ "

- DIN 3121 ISO 1174
- Chrome molybdenum alloy steel
- Phosphate sunk finish

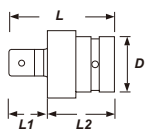

D mm	L mm	Code	g
24	48	54	103

### 12732-83

#### Impact Adapter $\frac{3}{8}$ "

- DIN 3121 ISO 1174
- Chrome molybdenum alloy steel
- Phosphate sunk finish

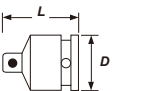

Size	D mm	L mm	Code	g
1/4" $\times$ 3/8" $\square$	22	32	1438	20
1/2" $\times$ 3/8" $\square$	22	37	1238	62

6

184  
185

Whirlpower

# IMPACT SOCKETS AND ACCESSORIES

## 12732-84

### Impact Adapter (Pin Hole) $\frac{3}{8}$ "

- DIN 3121 ISO 1174
- Chrome molybdenum alloy steel
- Phosphate sunk finish

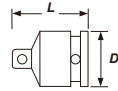

Size	D mm	L mm	Code	g
1/4" x 3/8"	22	32	1438	18
1/2" x 3/8"	22	37	1238	60

## 12732-91

### Impact Extension Bar $\frac{3}{8}$ "

- DIN 3121 ISO 1174
- Chrome molybdenum alloy steel
- Phosphate sunk finish

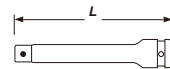

L mm	Code	g
75	075	85
150	150	150

## 12732-92

### Impact Extension Bar (Pin Hole) $\frac{3}{8}$ "

- DIN 3121 ISO 1174
- Chrome molybdenum alloy steel
- Phosphate sunk finish

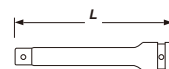

L mm	Code	g
75	075	83
150	150	148

## 12737-41

### Impact Bit Socket, TX $\frac{3}{8}$ "

- DIN 3121
- Chrome molybdenum alloy steel
- Phosphate sunk finish

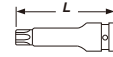

Size	L mm	Code	g
10	52	10	31
15	52	15	32
20	52	20	32
25	52	25	34
27	52	27	35
30	52	30	37
40	52	40	40
45	52	45	43
50	52	50	45

## 12737-61

### Impact Bit Socket, HX $\frac{3}{8}$ "

- DIN 3121
- Chrome molybdenum alloy steel
- Phosphate sunk finish

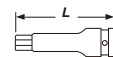

Size	L mm	Code	g
4	52	04	37
5	52	05	37
6	52	06	50
8	52	08	46
10	52	10	55
12	52	12	64

## 12739-01

### O-Ring $\frac{3}{8}$ "



Size	D mm	Code	g
8-12	13	13	1
13-22	16	16	1

### Pin $\frac{3}{8}$ "



Size	L mm	Code	g
8-12	14	20	1
13-22	16	25	1

## 12742-61

### Impact Sockets, 6-Point $\frac{1}{2}$ "

- DIN 3121 ISO 2725
- Chrome molybdenum alloy steel
- Phosphate sunk finish

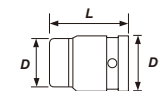

Size	D mm	D1 mm	L mm	Code	g
8	14	25	38	08	70
9	15	25	38	09	70
10	17	25	38	10	70
11	18	25	38	11	70
12	19	25	38	12	70
13	20	25	38	13	75
14	22	25	38	14	80
15	23	30	38	15	112
16	24	30	38	16	112
17	26	30	38	17	120
18	27	30	38	18	120
19	28	30	38	19	120
20	29	30	38	20	120
21	30	30	38	21	120
22	31.8	30	38	22	128
23	31.8	30	38	23	128
24	33.8	30	40	24	135
27	37.8	30	43	27	180
30	41.8	30	43	30	210
32	43.8	30	43	32	210
34	45.8	30	46	34	230

## 12742-32

### Impact Torqs Sockets $\frac{1}{2}$ "

- DIN 3121 ISO 2725
- Chrome molybdenum alloy steel
- Phosphate sunk finish

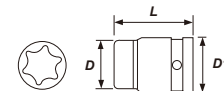

Size	D mm	D1 mm	L mm	Code	g
E8	12	25	38	08	85
E10	14.2	25	38	10	85
E11	15	25	38	11	85
E12	16	25	38	12	85
E14	18	25	38	14	85
E16	20	25	38	16	85
E18	22	25	38	18	85
E20	24	30	38	20	130
E22	25.5	30	45	22	160
E24	28	30	45	24	160

## 12742-62

### Impact Deep Sockets, 6-Point $\frac{1}{2}$ "

- DIN 3121 ISO 2725
- Chrome molybdenum alloy steel
- Phosphate sunk finish

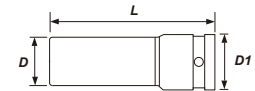

Size	D mm	D1 mm	L mm	Code	g
8	14	25	78	08	160
9	15	25	78	09	160
10	17	25	78	10	160
11	18	25	78	11	160
12	19	25	78	12	160
13	20	25	78	13	180
14	22	25	78	14	180
15	23	30	78	15	210
16	24	30	78	16	210
17	26	30	78	17	220
18	27	30	78	18	220
19	28	30	78	19	220
20	29	30	78	20	220
21	30	30	78	21	220
22	31.8	30	78	22	230
23	31.8	30	78	23	230
24	33.8	30	78	24	310
25	35	30	78	25	340
26	35.8	30	78	26	340
27	37.8	30	78	27	410
28	39.8	30	78	28	410
29	39.8	30	78	29	410
30	41.8	30	78	30	410
32	43.8	30	78	32	430

## 12742-81

### Impact Universal Joint $\frac{1}{2}$ "

- DIN 3121 ISO 1174
- Chrome molybdenum alloy steel
- Phosphate sunk finish

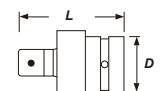

D mm	L mm	Code	g
28	63	64	170

# IMPACT SOCKETS AND ACCESSORIES

## 12742-82

### Impact Universal Joint (Pin Hole) 1/2"

- DIN 3121 ISO 1174
- Chrome molybdenum alloy steel
- Phosphate sunk finish



D mm	L mm	Code	g
28	63	64	168

## 12742-83

### Air Impact Adapter 1/2"

- DIN 3121 ISO 1174
- Chrome molybdenum alloy steel
- Phosphate sunk finish

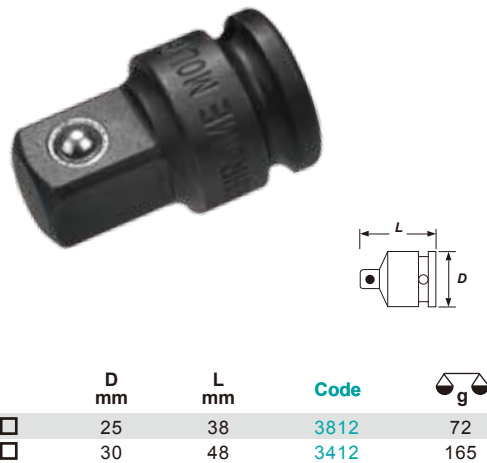

Size	D mm	L mm	Code	g
3/8" x 1/2"	25	38	3812	72
3/4" x 1/2"	30	48	3412	165

## 12742-84

### Air Impact Adapter (Pin Hole) 1/2"

- DIN 3121 ISO 1174
- Chrome molybdenum alloy steel
- Phosphate sunk finish



Size	D mm	L mm	Code	g
3/8" x 1/2"	25	38	3812	70
3/4" x 1/2"	30	48	3412	163

## 12742-91

### Impact Extension Bar 1/2"

- DIN 3121 ISO 1174
- Chrome molybdenum alloy steel
- Phosphate sunk finish



L mm	Code	g
75	75	220
125	125	425
250	250	440

## 12742-92

### Impact Extension Bar (Pin Hole) 1/2"

- DIN 3121 ISO 1174
- Chrome molybdenum alloy steel
- Phosphate sunk finish

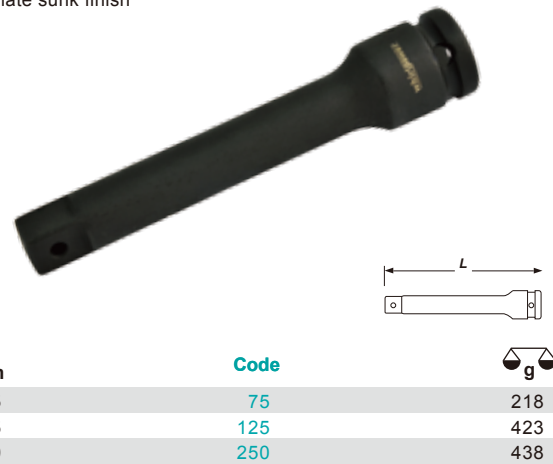

L mm	Code	g
75	75	218
125	125	423
250	250	438

## 12742-31

### Impact Deep Socket, Extra Long 1/2"

- DIN 3129 ISO 2725
- Chrome molybdenum alloy steel
- Phosphate sunk finish



Size	D mm	L mm	Code	g
17	26	150	170	400
19	28	150	190	423
21	30	150	210	455

## 12749-01

### O-Ring 1/2"

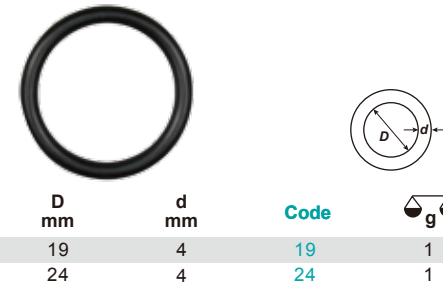

Size	D mm	d mm	Code	g
8-14	19	4	19	1
15-36	24	4	24	1

### Pin 1/2"

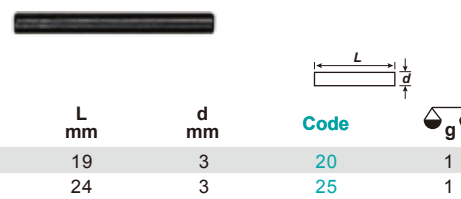

Size	L mm	d mm	Code	g
8-14	19	3	20	1
15-32	24	3	25	1

## 12742-41

### Locking Wheel Nut Remover 1/2"

- Alloy steel
- Phosphate sunk finish



Size	D mm	L mm	Code	g
17.0	24	38	170	69
18.5	25	38	185	72
21.5	29	38	215	104
26.0	32	38	260	128

## 12742-51

### Impact Locking Wheel Nut Remover 1/2"

- Alloy steel
- Phosphate sunk finish

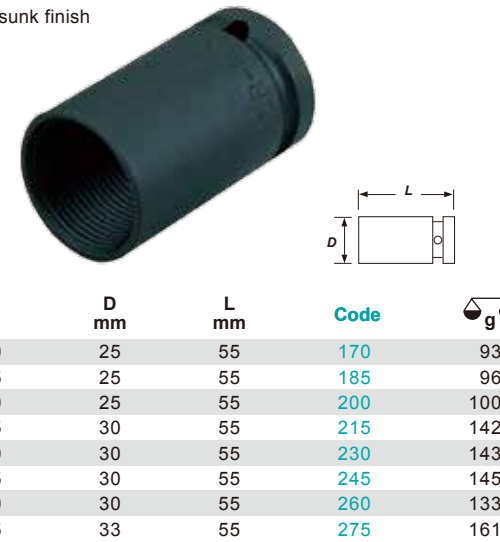

Size	D mm	L mm	Code	g
17.0	25	55	170	93
18.5	25	55	185	96
20.0	25	55	200	100
21.5	30	55	215	142
23.0	30	55	230	143
24.5	30	55	245	145
26.0	30	55	260	133
27.5	33	55	275	161

## 12743-11

### Wheel Nut Impact Deep Sockets, Extra Long 1/2"

- PP-covered
- Chrome molybdenum alloy steel
- Phosphate sunk finish

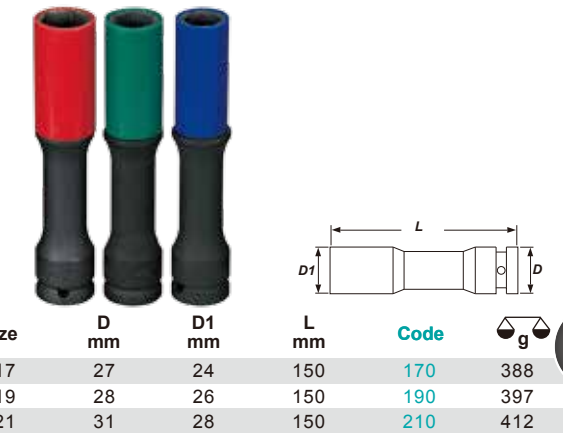

Size	D mm	D1 mm	L mm	Code	g
17	27	24	150	170	388
19	28	26	150	190	397
21	31	28	150	210	412

## 12743-21

### Wheel Nut Impact Deep Sockets 1/2"

- PP-covered
- Chrome molybdenum alloy steel
- Phosphate sunk finish

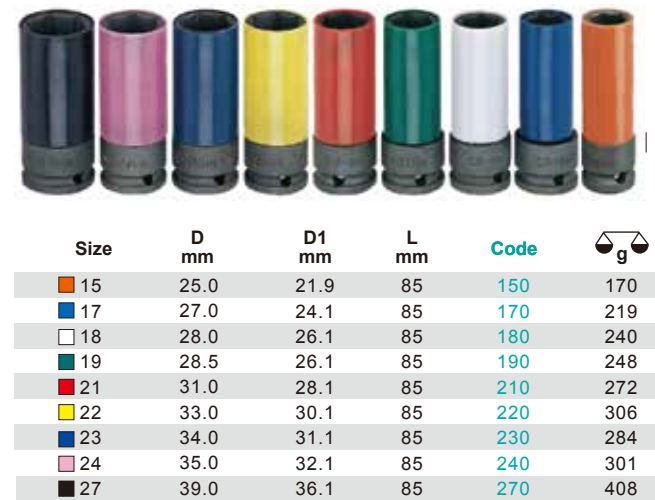

Size	D mm	D1 mm	L mm	Code	g
15	25.0	21.9	85	150	170
17	27.0	24.1	85	170	219
18	28.0	26.1	85	180	240
19	28.5	26.1	85	190	248
21	31.0	28.1	85	210	272
22	33.0	30.1	85	220	306
23	34.0	31.1	85	230	284
24	35.0	32.1	85	240	301
27	39.0	36.1	85	270	408

## 12743-23

### Wheel Nut Impact Deep Sockets 1/2"

- PP-covered
- Chrome molybdenum alloy steel
- Electro-deposit finish

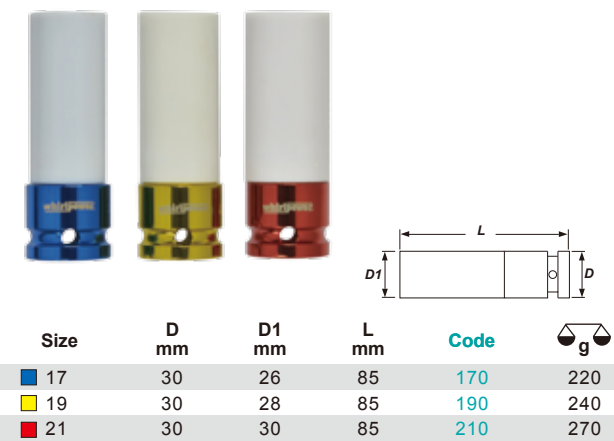

Size	D mm	D1 mm	L mm	Code	g
17	30	26	85	170	220
19	30	28	85	190	240
21	30	30	85	210	270

# IMPACT SOCKETS AND ACCESSORIES

## 12747-41

### Impact Bit Socket, TX $\frac{1}{2}$ "

- Chrome molybdenum alloy steel
- Phosphate sunk finish

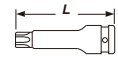

Size	L mm	Code	g
25	60	25S	60
30	60	30S	65
40	60	40S	68
45	60	45S	72
50	60	50S	86
55	60	55S	92
60	60	60S	107
70	60	70S	113
25	78	25	70
30	78	30	75
40	78	40	78
45	78	45	82
50	78	50	96
55	78	55	102
60	78	60	117
70	78	70	123

## 12747-61

### Impact Bit Socket, HX $\frac{1}{2}$ "

- Chrome molybdenum alloy steel
- Phosphate sunk finish

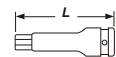

Size	L mm	Code	g
5	60	05S	64
6	60	06S	68
8	60	08S	80
10	60	10S	96
12	60	12S	112
14	60	14S	132
17	60	17S	195
5	78	05	74
6	78	06	78
8	78	08	90
10	78	10	106
12	78	12	122
14	78	14	142
17	78	17	205

## 12762-21

### Impact Socket, 6-Point $\frac{3}{4}$ "

- DIN 3121 ISO 2725
- Chrome molybdenum alloy steel
- Phosphate sunk finish

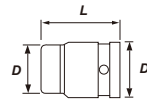

Size	D mm	D1 mm	L mm	Code	g
17	28.5	38	50	17	230
19	30	38	52	19	230
21	32	38	52	21	240
22	34	38	52	22	250
23	35	38	52	23	250
24	36	38	52	24	250
25	38	38	52	25	270
26	38	38	52	26	270
27	40	40	52	27	280
28	42	42	52	28	320
29	42	42	52	29	320
30	46	44	52	30	370
32	48	44	52	32	380
33	50	44	56	33	410
34	51	44	56	34	410
35	52	44	56	35	470
36	53.5	44	56	36	470
38	56	44	56	38	470
41	60	44	58	41	590
46	67	44	63	46	770
50	71	54	72	50	970
55	77	54	74	55	1250
60	84	54	80	60	1600
65	88	54	80	65	1650
70	96	54	85	70	1920

## 12762-81

### Impact Universal Joint (Pin Hole) $\frac{3}{4}$ "

- DIN 3121 ISO 2725
- Chrome molybdenum alloy steel
- Phosphate sunk finish

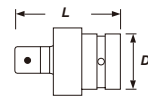

D mm	L mm	Code	g
44	90	100	540

## 12762-62

### Impact Deep Socket, 6-Point $\frac{3}{4}$ "

- DIN 3121 ISO 2725
- Chrome molybdenum alloy steel
- Phosphate sunk finish

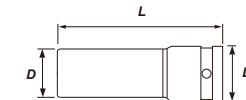

Size	D mm	D1 mm	L mm	Code	g
19	30	38	90	19	390
21	32	38	90	21	400
22	34	38	90	22	430
23	35	38	90	23	430
24	36	38	90	24	440
26	38	38	90	26	460
27	40	40	90	27	500
28	42	42	90	28	550
29	42	42	90	29	560
30	46	44	90	30	620
32	48	44	90	32	630
33	50	44	90	33	670
34	51	44	90	34	670
35	52	44	90	35	770
36	53	44	90	36	790
38	56	44	92	38	830
41	60	44	92	41	880
46	67	44	92	46	1150
50	71	54	95	50	1320
55	77	54	100	55	1690
60	84	54	105	60	2020
65	88	54	105	65	2300
70	96	54	105	70	2450

## 12762-82

### Impact Universal Joint (Pin Hole) $\frac{3}{4}$ "

- DIN 3121 ISO 1174
- Chrome molybdenum alloy steel
- Phosphate sunk finish

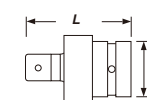

D mm	L mm	Code	g
44	90	100	538

## 12762-83

### Impact Adapter $\frac{3}{4}$ "

- DIN 3121 ISO 1174
- Chrome molybdenum alloy steel
- Phosphate sunk finish

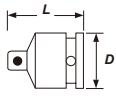

Size	D mm	L mm	Code	g
1/2" x 3/4"	44	56	1234	325
1" x 3/4"	44	64	8834	450

## 12762-84

### Impact Adapter (Pin Hole) $\frac{3}{4}$ "

- DIN 3121 ISO 1174
- Chrome molybdenum alloy steel
- Phosphate sunk finish

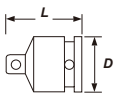

Size	D mm	L mm	Code	g
1/2" x 3/4"	44	56	1234	323
1" x 3/4"	44	64	8834	448

## 12762-85

### Impact Replaceable Adapter $\frac{3}{4}$ "

- Chrome molybdenum alloy steel
- Phosphate sunk finish



Size	D mm	L mm	Code	g
1/2" x 3/4"	44	61	1234	331

## Adapter $\frac{1}{2}$ "

- Chrome molybdenum alloy steel
- Phosphate sunk finish

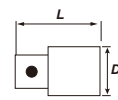

D mm	L mm	Code	g
19	30	30	45

# IMPACT SOCKETS AND ACCESSORIES

## 12762-91

### Impact Quick Release Extension Bar $\frac{3}{4}$ "

- DIN 3121 ISO 1174
- Chrome molybdenum alloy steel
- Phosphate sunk finish



L mm	Code	g
100	100	580
175	175	870
250	250	1160
325	325	1460

## 12762-92

### Impact Extension Bar $\frac{3}{4}$ "

- DIN 3121 ISO 1174
- Chrome molybdenum alloy steel
- Phosphate sunk finish



L mm	Code	g
100	100	540
175	175	850
250	250	1110
330	325	1450

## 12762-93

### Impact Extension Bar (Pin Hole) $\frac{3}{4}$ "

- DIN 3121 ISO 1174
- Chrome molybdenum alloy steel
- Phosphate sunk finish



L mm	Code	g
100	100	538
175	175	848
250	250	1108
330	325	1448

## 12769-01

### O-Ring $\frac{3}{4}$ "



Size	D mm	d mm	Code	g
13-26	32	5	32	3
27-29	35	5	35	3
30-49	38	5	38	4
50-70	48	5	48	5

### Pin $\frac{3}{4}$ "



Size	L mm	d mm	Code	g
13-26	31	4	31	3
27-29	34	4	34	3
30-49	37	4	37	4
50-70	47	4	47	5

## 12782-21

### Impact Sockets, 6-Point $1\frac{1}{2}$ "

- DIN 3121 ISO 2725
- Chrome molybdenum alloy steel
- Phosphate sunk finish



Size	D mm	D1 mm	L mm	Code	g
22	39	51	58	22	510
23	40	51	58	23	510
24	40.5	51	58	24	510
26	42.5	51	58	26	520
27	44	51	58	27	520
29	46	51	60	29	530
30	48	51	60	30	530
32	51	51	62	32	590
33	52	52	62	33	620
34	54	54	62	34	640
35	54	54	62	35	650
36	56	54	62	36	670
38	58	54	62	38	680
41	61.5	54	62	41	920
46	68	54	64	46	1000
50	73	54	70	50	1070
55	79	54	72	55	1440
60	87	54	78	60	1730
65	93	54	80	65	1900
70	98	54	85	70	2190
75	104	86	95	75	3200
80	109	86	100	80	3650
85	115	86	100	85	4100
90	125	86	105	90	5200
95	130	86	105	95	5250
100	137	95	105	100	6050
105	143	95	105	105	6550
110	147	95	105	110	7250
115	152	95	105	115	10000

## 12782-62

### Impact Deep Socket, 6-Point $1\frac{1}{2}$ "

- DIN 3121 ISO 2725
- Chrome molybdenum alloy steel
- Phosphate sunk finish



Size	D mm	D1 mm	L mm	Code	g
22	39	51	90	22	710
24	40.5	51	90	24	720
27	44	51	90	27	800
30	48	51	90	30	800
32	51	51	90	32	910
33	52	52	90	33	910
34	54	54	90	34	950
35	54	54	90	35	950
36	56	54	90	36	950
38	58	54	92	38	990
41	61.5	54	92	41	1200
46	68	54	92	46	1400
50	73	54	95	50	1570
55	79	54	100	55	1950
60	87	54	105	60	2350
65	93	54	120	65	2950
70	98	54	124	70	3300
75	104	86	135	75	4550
80	109	86	135	80	4850

## 12782-82

### Impact Universal Joint (Pin Hole) $1\frac{1}{2}$ "

- DIN 3121 ISO 1174
- Chrome molybdenum alloy steel
- Phosphate sunk finish



D mm	L mm	Code	g
54	110	110	1020

## 12782-84

### Impact Adapter (Pin Hole) $1\frac{1}{2}$ "

- DIN 3121 ISO 1174
- Chrome molybdenum alloy steel
- Phosphate sunk finish



Size	D mm	L mm	Code	g
$\frac{3}{4}$ " x 1"	54	75	75	570
$1\frac{1}{2}$ " x 1"	54	90	90	1120

## 12782-91

### Impact Extension Bar $1\frac{1}{2}$ "

- DIN 3121 ISO 2725
- Chrome molybdenum alloy steel
- Phosphate sunk finish



L mm	Code	g
175	175	1450
250	250	1980
330	325	2450

## 12782-92

### Impact Extension Bar (Pin Hole) $1\frac{1}{2}$ "

- DIN 3121 ISO 2725
- Chrome molybdenum alloy steel
- Phosphate sunk finish



L mm	Code	g
175	175	1448
250	250	1978
330	325	2448

# IMPACT SOCKETS AND ACCESSORIES

## 12789-01

### O-Ring 1"

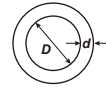

Size	D mm	d mm	Code	g
17-44	43	7	43	4
45-54	50	7	50	4
55-73	54	7	54	5
74-95	78	7	78	6
96-115	87	7	87	7

### Pin 1"

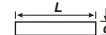

Size	D mm	d mm	Code	g
17-44	42	5	42	4
45-54	47	5	47	4
55-73	53	5	53	5
74-95	75	6	75	6
96-115	84	6	84	7

## 12792-21

### Impact Sockets, 6-Point 1 1/2"

- DIN 3121 ISO 2725
- Chrome molybdenum alloy steel
- Phosphate sunk finish

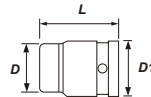

Size	D mm	D1 mm	L mm	Code	g
41	70	86	80	41	2200
46	76	86	84	46	2200
50	81	86	87	50	2400
55	87	86	90	55	2500
60	93	86	92	60	3100
65	97	86	95	65	3400
70	105	86	100	70	3800
75	110	86	103	75	4200
80	116	86	110	80	4650
85	125	86	118	85	5500
90	130	86	118	90	5800
95	137	95	118	95	6600
100	144	95	125	100	9300
105	150	95	125	105	9500
110	156	95	125	110	10500
115	160	95	135	115	12100
120	168	95	135	120	13200
125	175	95	135	125	14000
130	180	127	145	130	18000
135	186	127	150	135	19000
140	192	127	150	140	20000
145	198	127	150	145	21000
150	203	127	150	150	22000
155	209	127	150	155	24500
160	222	127	175	160	29800
165	228	127	175	165	32000
175	235	127	175	175	34500

## 12792-22

### Impact Deep Socket, 6-Point 1 1/2"

- DIN 3121 ISO 2725
- Chrome molybdenum alloy steel
- Phosphate sunk finish

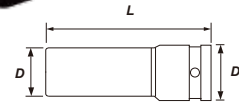

Size	D mm	D1 mm	L mm	Code	g
41	70	86	115	41	3200
46	76	86	115	46	3200
50	81	86	135	50	3200
55	87	86	140	55	3900
60	93	86	150	60	5150
65	97	86	150	65	5700
70	105	86	160	70	6700
75	110	86	170	75	7800
80	116	86	170	80	8600
85	125	86	170	85	9900
90	130	86	170	90	10700
95	137	95	180	95	12200
100	144	95	190	100	14100
105	150	95	190	105	15800
110	156	95	200	110	17000
115	160	95	200	115	20400
120	168	95	210	120	21500

## 12792-82

### Impact Universal Joint (Pin Hole) 1 1/2"

- DIN 3121 ISO 1174
- Chrome molybdenum alloy steel
- Phosphate sunk finish

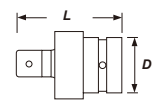

D mm	L mm	Code	g
86	150	150	3750

## 12792-84

### Impact Adapter (Pin Hole) 1 1/2"

- DIN 3121 ISO 1174
- Chrome molybdenum alloy steel
- Phosphate sunk finish

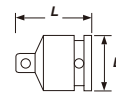

Size	D mm	L mm	Code	g
1" x 1 1/2"	86	100	100	2300
2 1/2" x 1 1/2"	86	120	120	3200

## 12792-92

### Impact Extension Bar (Pin Hole) 1 1/2"

- DIN 3121 ISO 2725
- Chrome molybdenum alloy steel
- Phosphate sunk finish

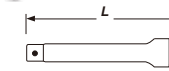

L mm	Code	g
125	125	2800
250	250	4600

## 12702-21

### Impact Sockets, 6-Point 2 1/2"

- DIN 3121 ISO 2725
- Chrome molybdenum alloy steel
- Phosphate sunk finish

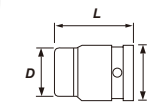

Size	D mm	D1 mm	L mm	Code	g
75	118	127	140	75	8600
80	124	127	140	80	8600
85	130	127	140	85	8600
90	136	127	145	90	8900
95	143	127	145	95	9600
100	149	127	150	100	10400
105	155	127	155	105	11500
110	161	127	160	110	12300
115	167	127	165	115	14100
120	176	127	170	120	15300
125	181	127	175	125	17000
130	188	127	175	130	18000
135	195	127	180	135	18600
140	202	127	180	140	19700
145	208	127	185	145	20700
150	215	127	185	150	22300
155	223	127	190	155	23600
160	227	127	190	160	24700
165	235	127	195	165	26900
170	241	127	195	170	27000
175	248	127	200	175	28900
180	254	127	200	180	29500
185	258	152	210	185	34800
190	265	152	210	190	36100
200	275	152	220	200	38900
210	288	152	225	210	48900
215	293	152	225	215	48900
220	298	152	225	220	59000
230	304	152	225	230	59000
235	316	152	225	235	69000
240	327	152	225	240	79000
250	333	152	225	250	80000
255	338	152	225	255	89900
260	342	152	225	260	90000

## 12702-82

### Impact Universal Joint (Pin Hole) 2 1/2"

- DIN 3121 ISO 1174
- Chrome molybdenum alloy steel
- Phosphate sunk finish

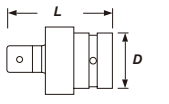

D mm	L mm	Code	g
127	230	230	12370

## 12702-84

### Impact Adapter (Pin Hole) 2 1/2"

- DIN 3121 ISO 1174
- Chrome molybdenum alloy steel
- Phosphate sunk finish

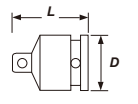

Size	D mm	L mm	Code	g
1 1/2" x 2 1/2"	127	138	138	6350

## 1273-0207

### Impact Bit Socket, TX Set, 7pcs 3/8"



Series	Contents	g
7 12737-41	3/8" Impact Bit Socket, TX, 52mm ⌀20, 25, 30, 40, 45, 50, 55	325g

## 1273-0307

### Impact Bit Socket, HX Set, 7pcs 3/8"



Series	Contents	g
7 12737-61	3/8" Impact Bit Socket, HX, 52mm ⌀4, 5, 6, 7, 8, 10, 12	390g

# IMPACT SOCKET SETS

## 1274-1707

Impact Sockets Set, 7pcs  $\frac{1}{2}$ "



Series	Contents	Weight
7 12742-61	1/2" Impact Sockets, 6-Point 10, 13, 17, 19, 22, 24, 27mm	Weight: 794g

## 1274-1807

Impact Torqs Sockets Set, 7pcs  $\frac{1}{2}$ "



Series	Contents	Weight
7 12742-32	1/2" Impact Torqs Sockets E10, E12, E14, E16, E18, E20, E24	Weight: 670g

## 1274-1908

Impact Bit Socket, HX Set, 8pcs  $\frac{1}{2}$ "



Series	Contents	Weight
8 12747-61	1/2" Impact Bit Socket, HX, 60mm ● 5, 6, 8, 10, 12, 14, 17, 19	Weight: 877g

## 1274-2008

Impact Bit Socket, HX Set, 8pcs  $\frac{1}{2}$ "



Series	Contents	Weight
8 12747-61	1/2" Impact Bit Socket, HX, 78mm ● 5, 6, 8, 10, 12, 14, 17, 19	Weight: 1.2kg

## 1274-2108

Impact Bit Socket, TX Set, 8pcs  $\frac{1}{2}$ "



Series	Contents	Weight
8 12747-41	1/2" Impact Bit Socket, TX, 60mm ⊕ 25, 30, 40, 45, 50, 55, 60, 70	Weight: 744g

## 1274-2208

Impact Bit Socket, TX Set, 8pcs  $\frac{1}{2}$ "



Series	Contents	Weight
8 12747-41	1/2" Impact Bit Socket, TX, 78mm ⊕ 25, 30, 40, 45, 50, 55, 60, 70	Weight: 800g

## 1274-2312

Impact Sockets Set, 12pcs  $\frac{1}{2}$ "



Series	Contents	Weight
6 12742-61	1/2" Impact Sockets, 6-Point 17, 18, 19, 21, 22, 24mm	Weight: 2.38kg
6 12742-62	1/2" Impact Deep Sockets, 6-Point 17, 18, 19, 21, 22, 24mm	

## 1274-IS01

Impact Socket Set, 14pcs  $\frac{1}{2}$ "



Series	Contents	Weight
14 12742-62	1/2" Impact Deep Sockets 10, 11, 12, 13, 14, 15, 16, 17, 18, 19, 21, 22, 23, 24mm	Weight: 2.83kg

## 1274-IS02

Impact Socket Set, 19pcs  $\frac{1}{2}$ "



Series	Contents	Weight
17 12742-61	1/2" Impact Sockets 10, 11, 12, 13, 14, 15, 16, 17, 18, 19, 21, 22, 23, 24, 27, 30, 32mm	Weight: 2.57kg
1 12742-81	1/2" Impact Universal Joint, 64mm	
1 12742-91	1/2" Impact Extension Bar, 125 mm	

## 1274-IS03

Impact Socket Set, 27pcs  $\frac{1}{2}$ "



Series	Contents	Weight
17 12742-61	1/2" Impact Sockets 10, 11, 12, 13, 14, 15, 16, 17, 18, 19, 21, 22, 23, 24, 27, 30, 32mm	Weight: 2.57kg
1 12742-82	1/2" Impact Universal Joint (Pin Hole), 64mm	
1 12742-92	1/2" Impact Extension Bar (Pin Hole), 125 mm	
8 12749-01	1/2" O-Ring, Size(8-14)x2, Size(15-32)x2 1/2" Pin, Size(8-14)x2, Size(15-32)x2	

## 1274-2613

Impact Socket Set, 13pcs  $\frac{1}{2}$ "



Series	Contents	Weight
7 12742-32	1/2" Impact Torqs Sockets E10, E12, E14, E16, E18, E20, E24	Weight: 1.57kg
6 12747-41	1/2" Impact Bit Socket, TX, 60mm ⊕ 30, 40, 45, 50, 55, 60	

## 1276-0408

Impact Socket Set, 8pcs  $\frac{3}{4}$ "



Series	Contents	Weight
8 12762-21	3/4" Impact Sockets, 6-Point 26, 29, 30, 32, 34, 35, 36, 38mm	Weight: 4.52kg



### 1276-0508

Impact Socket Set, 8pcs **3/4"**



Series	Contents	Weight
8 12762-62	3/4" Impact Deep Sockets, 6-Point 26, 29, 30, 32, 34, 35, 36, 38mm	7.28kg

### 1278-0209

Impact Socket Set, 9pcs **1"**



Series	Contents	Weight
9 12782-21	1" Impact Sockets, 6-Point 24, 27, 29, 30, 32, 33, 36, 38, 41mm	7.2kg

### D05-0687

Impact Socket Set, 87pcs

• With Shelf And Display Board



Series	Contents
87 12742-61	10x6, 11x6, 12x6, 13x6, 14x6, 15x5, 16x5, 17x5, 18x5, 19x5, 21x5, 22x5, 23x5, 24x5, 27x4, 30x4, 32mmx4

## IMPACT SOCKET SETS

### 1274-0503

Extra Long Wheel Nut Socket Set, 3pcs **1/2"**



Series	Contents	Weight
3 12743-11	1/2" Wheel Nut Impact Deep Socket Extra Long, 17, 19, 21mm	1600g

### 1274-0603

Wheel Nut Impact Deep Socket Set, 3pcs **1/2"**



Series	Contents	Weight
3 12743-21	1/2" Wheel Nut Impact Deep Socket 17, 19, 21mm	925g

### 1274-1703

Wheel Nut Impact Deep Socket Set, 3pcs **1/2"**



Series	Contents	Weight
3 12743-23	1/2" Wheel Nut Impact Deep Socket 17, 19, 21mm	823g

## SOCKETS AND ACCESSORIES

- High quality Chrome Vanadium Steel
- 30% higher torque strength than DIN standard
- Various types to fulfill all kind of needs
- Durable, high precision and long service life

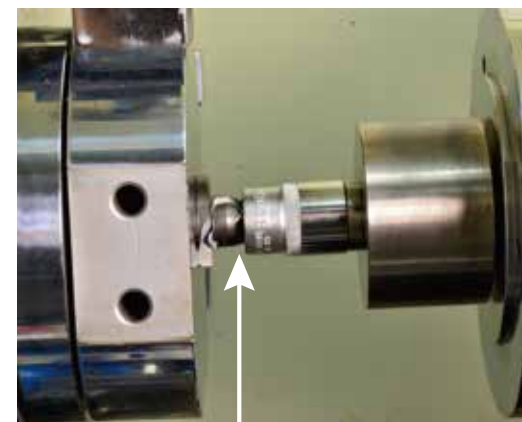

Tough - under the torque test, Socket remains complete even after the tester is broken.

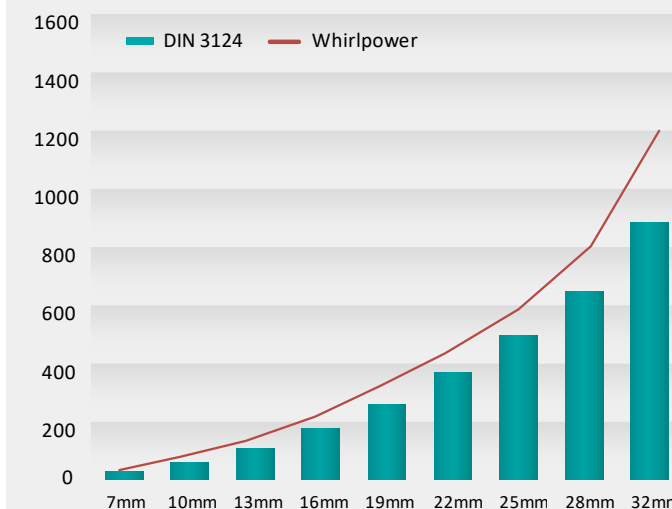

### Magnetic Tool set, 4pcs

- 1/4" Dr socket-7~14mm
- 3/8" Dr socket-6~8mm
- 3/8" Dr socket-9~22mm
- 1/2" Dr socket-10~23mm
- 1/2" Dr socket-24~34mm

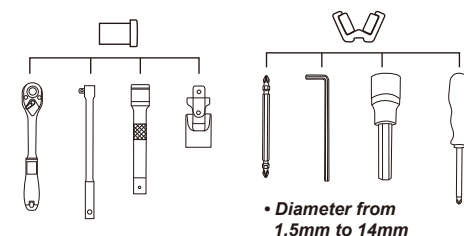
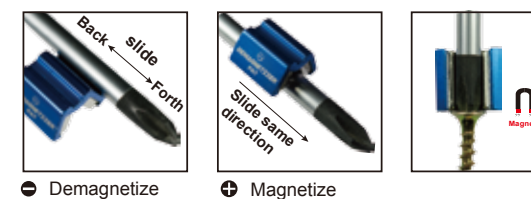
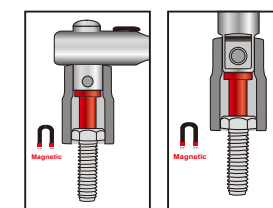

• Diameter from 1.5mm to 14mm



### RATCHET HANDEL

- Curved shank for easy operation
- Both 36 teeth and 72 teeth available
- Durability - Superior torque strength and long service life

# SOCKETS AND ACCESSORIES



## HAND SOCKETS AND ACCESSORIES

### 16121-11

#### Socket, 6-Point $\frac{1}{4}$ "

- DIN 3124 ISO 2725
- Chrome vanadium steel
- Mat chrome finish

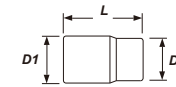

Size	D1 mm	D2 mm	L mm	Code	$\frac{g}{g}$
3.2	5.9	11.8	25	032S	10
4	6.7	11.8	25	040S	10
4.5	7.2	11.8	25	045S	10
5	8.0	11.8	25	050S	10
5.5	8.7	11.8	25	055S	10
6	9.3	11.8	25	060S	11
7	10.6	11.8	25	070S	11
8	11.9	11.8	25	080S	12
9	12.8	11.8	25	090S	15
10	13.8	12.0	25	100S	16
11	15.6	14.0	25	110S	23
12	16.8	15.0	25	120S	25
13	17.8	16.1	25	130S	29
14	19.7	17.0	25	140S	36

### 16121-21

#### SAE Socket, 6-Point $\frac{1}{4}$ "

- Chrome vanadium steel
- Mirror chrome finish

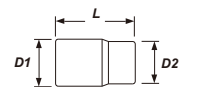

Size	D1 mm	D2 mm	L mm	Code	$\frac{g}{g}$
1/8"	5.9	11.8	25	0432	10
5/32"	6.7	11.8	25	0532	10
3/16"	8.0	11.8	25	0632	10
7/32"	8.7	11.8	25	0732	10
1/4"	9.3	11.8	25	0832	10
9/32"	10.6	11.8	25	0932	11
5/16"	11.9	11.8	25	1032	11
11/32"	12.8	11.8	25	1132	12
3/8"	12.8	11.8	25	1232	15
13/32"	13.8	12.0	25	1332	16
7/16"	15.6	14.0	25	1432	23
15/32"	16.8	15.0	25	1532	25
1/2"	17.8	16.1	25	1632	29
9/16"	19.7	17.0	25	1832	36

### 16121-12

#### Deep Socket, 6-Point $\frac{1}{4}$ "

- DIN 3124 ISO 2725
- Chrome vanadium steel
- Mat chrome finish

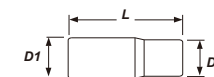

Size	D1 mm	D2 mm	L mm	Code	$\frac{g}{g}$
4	6.7	11.8	50	040S	20
4.5	7.2	11.8	50	045S	20
5	8.0	11.8	50	050S	20
5.5	8.7	11.8	50	055S	20
6	9.3	11.8	50	060S	20
7	10.6	11.8	50	070S	20
8	11.9	11.8	50	080S	24
9	12.8	11.8	50	090S	30
10	13.8	12.0	50	100S	36
11	15.6	14.0	50	110S	46
12	16.8	15.0	50	120S	50
13	17.8	16.1	50	130S	52
14	19.7	17.0	50	140S	54

### 16121-22

#### SAE Deep Socket, 6-Point $\frac{1}{4}$ "

- Chrome vanadium steel
- Mirror chrome finish



Size	D1 mm	D2 mm	L mm	Code	$\frac{g}{g}$
5/32"	6.7	11.8	50	0532	20
3/16"	7.2	11.8	50	0632	20
7/32"	8.0	11.8	50	0732	20
1/4"	8.7	11.8	50	0832	20
9/32"	9.3	11.8	50	0932	20
5/16"	10.6	11.8	50	1032	20
11/32"	11.9	11.8	50	1132	24
3/8"	12.8	11.8	50	1232	30
13/32"	13.8	12.0	50	1332	36
7/16"	15.6	14.0	50	1432	46
15/32"	16.8	15.0	50	1532	50
1/2"	17.8	16.1	50	1632	52

# HAND SOCKETS AND ACCESSORIES

## 16121-31

### Torks Socket

- Chrome vanadium steel
- Mirror and mat chrome finish

1/4"

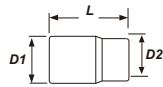

Size	D1 mm	D2 mm	L mm	Code	g
E4	6.7	11.8	25	040	10
E5	7.2	11.8	25	050	10
E6	8.0	11.8	25	060	10
E7	9.3	11.8	25	070	11
E8	10.0	11.8	25	080	11
E10	13.0	13.6	25	100	16
E11	15.6	15.6	25	110	20

## 16121-32

### Torks Deep Socket

- Chrome vanadium steel
- Mirror and mat chrome finish

1/4"

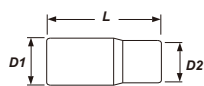

Size	D1 mm	D2 mm	L mm	Code	g
E4	6.7	11.8	50	040	14
E5	7.2	11.8	50	050	16
E6	8.0	11.8	50	060	20
E7	9.3	11.8	50	070	20
E8	10.0	11.8	50	080	24
E10	13.0	13.6	50	100	36

## 16122-16

### Mini Ratchet Handle

- Chrome vanadium steel
- Mirror chrome finish

1/4" 72T

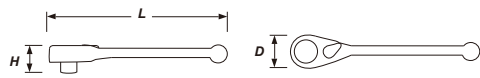

Teeth	D mm	H mm	L mm	Code	g
72	18.6	16	95	95	54

## 16122-17

### Mini Ratchet Handle

- Chrome vanadium steel
- Mirror chrome finish

1/4" 72T

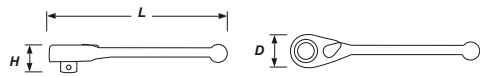

Teeth	D mm	H mm	L mm	Code	g
72	18.6	17.8	95	95	54

## 16122-03

### Ratchet Handle

- DIN 3122 ISO 3315
- Chrome vanadium steel
- Mirror chrome finish

1/4" 45T

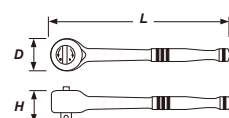

Teeth	D mm	H mm	L mm	Code	g
45	27	26	140	140	140

## 16122-04

### Ratchet Handle, Straight

- DIN 3122 ISO 3315
- Chrome vanadium steel
- Mat chrome finish

1/4" 36T 72T

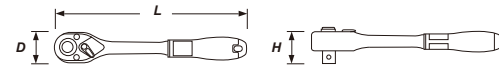

Teeth	D mm	H mm	L mm	Code	g
36	25	20	147	36	111
72	25	20	147	72	111

### Repair Kit



Teeth	Code
36	36T
72	72T

## 16122-05

### Ratchet Handle, Curved

- DIN 3122 ISO 3315
- Chrome vanadium steel
- Mat chrome finish

1/4" 36T 72T

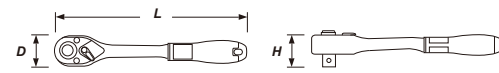

Teeth	D mm	H mm	L mm	Code	g
36	25	20	147	36	111
72	25	20	147	72	111

### Repair Kit



Teeth	Code
36	36T
72	72T

## 16122-07

### Swivel Ratchet Handle

- DIN 3122 ISO 3315
- Chrome vanadium steel
- Mat chrome finish

1/4" 72T

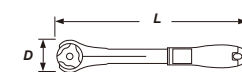

Teeth	D mm	L mm	Code	g
72	31	145	72	145

## 16122-08

### Stubby Ratchet Handle

- DIN 3122 ISO 3315
- Chrome vanadium steel
- Mat chrome finish

1/4" 36T

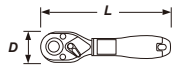

Teeth	D mm	L mm	Code	g
36	25	108	36	364

## 16122-13

### Ratchet T Handle

- Maximum torque: 65Nm

1/4" 72T

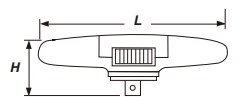

Teeth	H mm	L mm	Code	g
72	30	118	72	77

## 16122-14

### Ratchet Handle

- Chrome vanadium steel
- Satin chrome finish

1/4" 36T

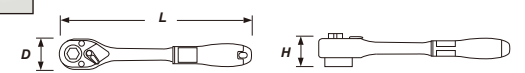

Teeth	D mm	H mm	L mm	Code	g
36	25	18	145	36	128

## 16122-15

### Swivel Stubby Ratchet Handle

- DIN 3122 ISO 3315
- Chrome vanadium steel
- Mat chrome finish

1/4" 72T

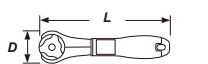

Teeth	D mm	L mm	Code	g
72	31	115	72	137

# HAND SOCKETS AND ACCESSORIES

## 16122-20

### Adjustable Ratchet Handle $\frac{1}{4}$ " 72T

- Chrome vanadium steel
- Driver head :Chrome molybdenum alloy steel
- Satin chrome finish

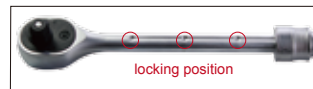

Teeth	D mm	H mm	Position	Extend range mm	Code	g
72	25	20	3	150-200	72	111

## 16122-06

### Swivel Handle $\frac{1}{4}$ "

- DIN 3122 ISO 3315
- Chrome vanadium steel
- Mat chrome finish

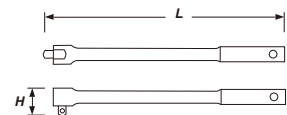
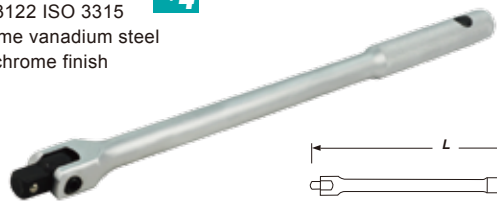

H mm	L mm	Code	g
28	150	150	120

## 16122-18

### Swivel Handle $\frac{1}{4}$ "

- DIN 3122 ISO 3315
- Chrome vanadium steel
- Mat chrome finish

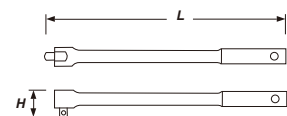
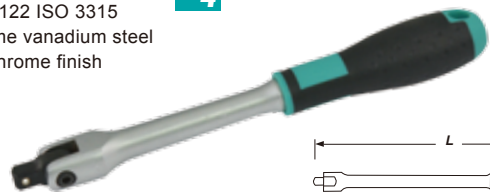

H mm	L mm	Code	g
28	160	160	140

## Repair Kit



Code

Repair kit 3T

## 16123-01

### Wobble Extension Bar $\frac{1}{4}$ "

- DIN 3123 ISO 3316
- Chrome vanadium steel
- Mat chrome finish



L mm	Code	g
50	050	25
75	075	35
100	100	45
150	150	65
225	225	96

## 16123-02

### Extension Bar $\frac{1}{4}$ "

- DIN 3123 ISO 3316
- Chrome vanadium steel
- Mat chrome finish

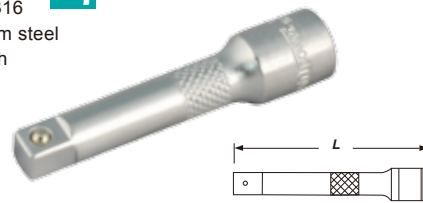

L mm	Code	g
55	050	25
75	075	35
100	100	45
150	150	65

## 16123-04

### Flexible Extension Bar $\frac{1}{4}$ "

- Chrome vanadium steel
- Chrome plated



L mm	Code	g
150	145	57

## 16124-01

### Sliding T Bar $\frac{1}{4}$ "

- DIN 3122 ISO 3315
- Chrome vanadium steel
- Mat chrome finish

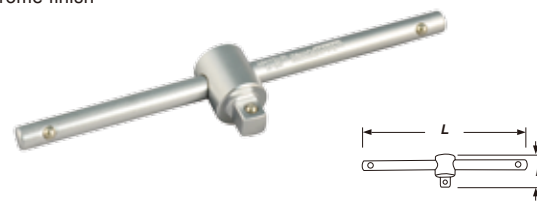

H mm	L mm	Code	g
24	115	115	35

## 16124-04

### Spinner Handle $\frac{1}{4}$ "

- DIN 3122 ISO 3315
- Chrome vanadium steel
- Mat chrome finish



L mm	L1 mm	Code	g
145	60	145	64

## 16124-05

### Speedy Spinner Handle $\frac{1}{4}$ "

- DIN 3122 ISO 3315
- Chrome vanadium steel
- Mat chrome finish



L mm	L1 mm	Code	g
150	60	150	120

## 16125-01

### Universal Joint $\frac{1}{4}$ "

- DIN 3123 ISO 3316
- Chrome vanadium steel
- Mat chrome finish



D mm	L mm	Code	g
14	40	40	27

## 16125-04

### Adapter $\frac{1}{4}$ "

- DIN 3123 ISO 3316
- Chrome vanadium steel
- Mat chrome finish



Size	D mm	L mm	Code	g
3/8" x 1/4"	14	26	3814	15

## 16125-06

### Coupler $\frac{1}{4}$ "

- DIN 3124 ISO 2725
- Chrome vanadium steel
- Mat chrome finish



Hex x DR	D mm	L mm	Code	g
1/4" x 1/4"	12	25	1414	15

## 16127-11

### Bit Sockets, SL $\frac{1}{4}$ "

- DIN ISO 2380-1, DIN 3120
- Socket double finish
- Chrome vanadium steel
- Bit silicon alloy steel (S2)



a	b	L mm	Code	g
0.5	3.0	32	032030	12
0.8	4.0	32	032040	12
1.0	5.5	32	032055	12
1.2	6.5	32	032065	12
1.6	8.0	32	032080	12

## 16127-21

### Bit Sockets, PH $\frac{1}{4}$ "

- DIN ISO 8764-1, DIN 3120
- Socket double finish
- Chrome vanadium steel
- Bit silicon alloy steel (S2)

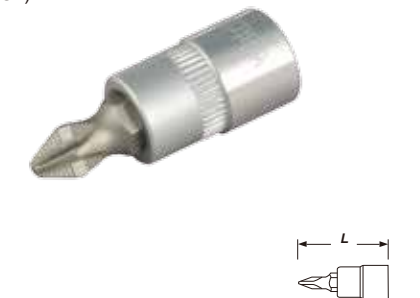

+	L mm	Code	g
0	32	0320	12
1	32	0321	12
2	32	0322	12
3	32	0323	12
4	32	0324	12

# HAND SOCKETS AND ACCESSORIES

## 16127-31

### Bit Sockets, PZ $\frac{1}{4}$ "

- DIN ISO 8764-1, DIN 3120
- Socket double finish
- Chrome vanadium steel
- Bit silicon alloy steel (S2)



⊛	L mm	Code	g
0	32	0320	12
1	32	0321	12
2	32	0322	12
3	32	0323	12
4	32	0324	12

## 16127-41

### Bit Sockets, TX $\frac{1}{4}$ "

- DIN 3120
- Socket double finish
- Chrome vanadium steel
- Bit silicon alloy steel (S2)



⊛	L mm	Code	g
8	32	03208	12
9	32	03209	12
10	32	03210	12
15	32	03215	14
20	32	03220	14
25	32	03225	14
27	32	03227	14
30	32	03230	14
40	32	03240	14

## 16127-51

### Bit Sockets, TX Tamper-Proof $\frac{1}{4}$ "

- DIN 3120
- Socket double finish
- Chrome vanadium steel
- Bit silicon alloy steel (S2)



⊛	L mm	Code	g
8	32	03208	12
9	32	03209	12
10	32	03210	12
15	32	03215	14
20	32	03220	14
25	32	03225	14
27	32	03227	14
30	32	03230	14
40	32	03240	14

## 16127-52

### Bit Sockets, TS (Five-sided) $\frac{1}{4}$ "

- DIN 3120
- Socket double finish
- Chrome vanadium steel
- Bit silicon alloy steel (S2)



⊛	L mm	Code	g
10	32	03210	12
15	32	03215	12
20	32	03220	13
25	32	03225	13
27	32	03227	14
30	32	03230	14
40	32	03240	14

## 16127-61

### Bit Sockets, HX $\frac{1}{4}$ "

- DIN 7422, DIN 3120
- Socket double finish
- Chrome vanadium steel
- Bit silicon alloy steel (S2)

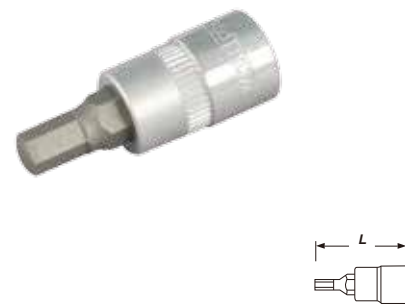

⬢	L mm	Code	g
3.0	32	032030	12
4.0	32	032040	12
5.0	32	032050	12
6.0	32	032060	14
7.0	32	032070	14
8.0	32	032080	16
10.0	32	032100	16
1/8"	32	032216	20
5/32"	32	032532	12
3/16"	32	032316	12
7/32"	32	032732	12
1/4"	32	032416	14
5/16"	32	032516	14
3/8"	32	032616	16

## 16131-11

### Sockets, 6-Point $\frac{3}{8}$ "

- DIN 3124 ISO 2725
- Chrome vanadium steel
- Mat chrome finish

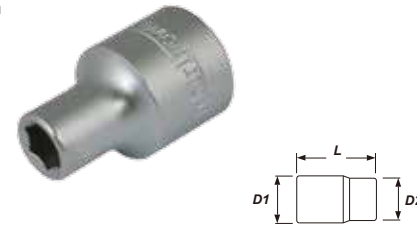

Size	D1 mm	D2 mm	L mm	Code	g
6	9.6	16.8	28	060S	25
7	11.0	16.8	28	070S	25
8	12.2	16.8	28	080S	25
9	13.5	16.8	28	090S	25
10	14.7	16.8	28	100S	25
11	16.0	16.8	28	110S	25
12	17.8	17.8	28	120S	25
13	18.8	18.8	28	130S	28
14	19.8	18.0	28	140S	38
15	21.8	19.0	28	150S	40
16	21.8	20.0	28	160S	41
17	23.8	21.0	28	170S	59
18	25.8	22.0	30	180S	68
19	25.8	23.0	30	190S	68
20	27.8	23.0	30	200S	65
21	27.8	24.0	30	210S	65
22	29.8	25.0	30	220S	83
23	31.7	26.0	30	230S	87
24	31.8	27.0	30	240S	87

## 16131-12

### Deep Sockets, 6-Point $\frac{3}{8}$ "

- DIN 3124 ISO 2725
- Chrome vanadium steel
- Mat chrome finish



Size	D1 mm	D2 mm	L mm	Code	g
6	9.6	16.8	63	060S	50
7	11.0	16.8	63	070S	50
8	12.2	16.8	63	080S	50
9	13.5	16.8	63	090S	50
10	14.7	16.8	63	100S	50
11	16.0	16.8	63	110S	50
12	17.8	17.8	63	120S	64
13	18.8	18.8	63	130S	64
14	19.8	18.0	63	140S	74
15	21.8	19.0	63	150S	74
16	21.8	20.0	63	160S	85
17	23.8	21.0	63	170S	103
18	25.8	22.0	63	180S	123
19	25.8	23.0	63	190S	116
20	27.8	23.0	63	200S	143
21	27.8	24.0	63	210S	139
22	29.8	25.0	63	220S	171
23	31.7	26.0	63	230S	198
24	31.8	27.0	63	240S	178

## 16131-21

### SAE Sockets, 6-Point $\frac{3}{8}$ "

- Chrome vanadium steel
- Mirror chrome finish

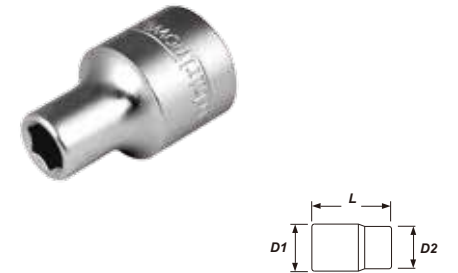

Size	D1 mm	D2 mm	L mm	Code	g
5/16"	12.2	16.8	28	1032	25
11/32"	13.5	16.8	28	1132	25
3/8"	14.7	16.8	28	1232	25
13/32"	14.7	16.8	28	1332	25
7/16"	16.0	16.8	28	1432	25
15/32"	17.8	17.8	28	1532	28
1/2"	18.8	18.8	28	1632	28
9/16"	19.8	18.0	28	1832	38
5/8"	21.8	20.0	28	2032	41
11/16"	23.8	21.0	28	2232	59
3/4"	25.8	23.0	30	2432	68
13/16"	27.8	24.0	30	2632	65
7/8"	29.8	25.0	30	2832	83

## 16131-22

### SAE Deep Sockets, 6-Point $\frac{3}{8}$ "

- Chrome vanadium steel
- Mirror chrome finish

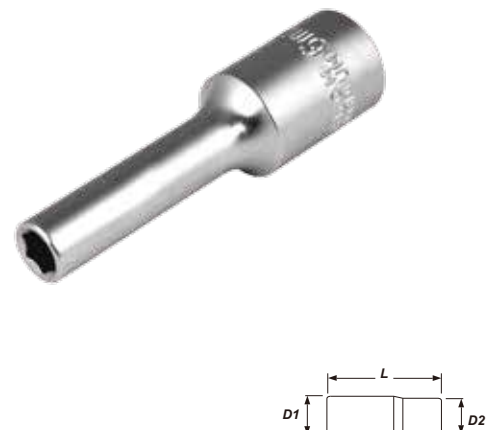

Size	D1 mm	D2 mm	L mm	Code	g
3/8"	14.7	16.8	63	1232	50
7/16"	16.0	16.8	63	1432	50
1/2"	18.8	16.8	63	1632	64
9/16"	19.8	18.0	63	1832	74
5/8"	21.8	20.0	63	2032	85
11/16"	23.8	21.0	63	2232	103
3/4"	25.8	23.0	63	2432	116
13/16"	27.8	24.0	63	2632	160
7/8"	29.8	25.0	63	2832	196

# HAND SOCKETS AND ACCESSORIES

## 16131-31

### Torks Sockets

3/8"

- Chrome vanadium steel
- Mirror and mat chrome finish

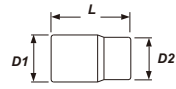

Size	D1 mm	D2 mm	L mm	Code	g
E6	7.9	16.8	28	060	20
E7	8.9	16.8	28	070	20
E8	10.9	16.8	28	080	22
E10	14.3	16.8	28	100	24
E11	13.4	16.8	28	110	26
E12	15.5	16.8	28	120	26
E14	17.8	16.6	28	140	30
E16	19.8	18.0	28	160	37
E18	21.8	19.1	28	180	42
E20	23.9	20.1	28	200	52

## 16131-32

### Torks Deep Sockets

3/8"

- Chrome vanadium steel
- Mirror and mat chrome finish

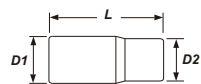

Size	D1 mm	D2 mm	L mm	Code	g
E6	7.9	16.8	63	060	50
E7	8.9	16.8	63	070	54
E8	10.9	16.8	63	080	54
E10	14.3	16.8	63	100	68
E11	13.4	16.8	63	110	68
E12	15.5	16.8	63	120	68
E14	17.8	16.6	63	140	82
E16	19.8	18.0	63	160	88

## 16131-41

### Sockets, 12-Point

3/8"

- DIN 3124, ISO 2725
- Chrome vanadium steel
- Mat chrome finish

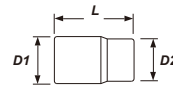

Size	D1 mm	D2 mm	L mm	Code	g
6	9.6	16.8	28	060S	25
7	11.0	16.8	28	070S	25
8	12.2	16.8	28	080S	25
9	13.5	16.8	28	090S	25
10	14.7	16.8	28	100S	25
11	16.0	16.8	28	110S	25
12	17.8	17.8	28	120S	25
13	18.8	18.8	28	130S	28
14	19.8	18.0	28	140S	38
15	21.8	19.0	28	150S	40
16	21.8	20.0	28	160S	41
17	23.8	21.0	28	170S	59
18	25.8	22.0	30	180S	68
19	25.8	23.0	30	190S	68
20	27.8	23.0	30	200S	65
21	27.8	24.0	30	210S	65
22	29.8	25.0	30	220S	83
23	31.7	26.0	30	230S	87
24	31.8	27.0	30	240S	87

## 16131-51

### SAE Socket, 12-Point

3/8"

- Chrome vanadium steel
- Mirror chrome finish

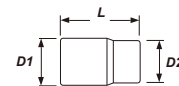

Size	D1 mm	D2 mm	L mm	Code	g
5/16"	12.2	16.8	28	1032	25
11/32"	13.5	16.8	28	1132	25
3/8"	14.7	16.8	28	1232	25
13/32"	14.7	16.8	28	1332	25
7/16"	16.0	16.8	28	1432	25
15/32"	17.8	17.8	28	1532	28
1/2"	18.8	18.8	28	1632	28
9/16"	19.8	18.0	28	1832	38
5/8"	21.8	20.0	28	2032	41
11/16"	23.8	21.0	28	2232	59
3/4"	25.8	23.0	30	2432	68
13/16"	27.8	24.0	30	2632	65
7/8"	29.8	25.0	30	2832	83

## 16132-01

### Ratchet Handle

3/8"

45T

- DIN 3122 ISO 3315
- Chrome vanadium steel
- Mirror chrome finish

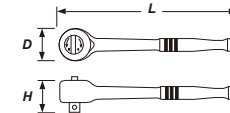
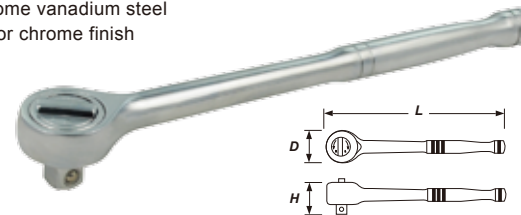

Teeth	D mm	H mm	L mm	Code	g
45	35	34	200	200	350

## 16132-02

### Ratchet Handle, Straight

3/8"

36T

72T

- DIN 3122 ISO 3315
- Chrome vanadium steel
- Mat chrome finish

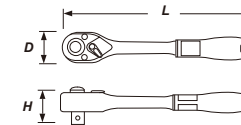
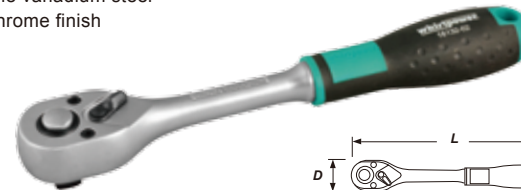

Teeth	D mm	H mm	L mm	Code	g
36	31	26	202	36	244
72	31	26	202	72	244

### Repair Kit



Teeth	Code
36	36T
72	72T

## 16132-03

### Ratchet Handle, Curved

3/8"

36T

72T

- DIN 3122 ISO 3315
- Chrome vanadium steel
- Mat chrome finish

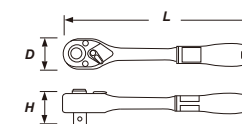

Teeth	D mm	H mm	L mm	Code	g
36	31	26	202	36	244
72	31	26	202	72	244

### Repair Kit



Teeth	Code
36	36T
72	72T

## 16132-06

### Swivel Ratchet Handle

3/8"

72T

- DIN 3122 ISO 3315
- Chrome vanadium steel
- Mat chrome finish

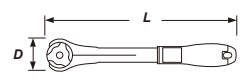

Teeth	D mm	L mm	Code	g
72	43	230	230	410

## 16132-07

### Stubby Ratchet Handle

3/8"

36T

- DIN 3122 ISO 3315
- Chrome vanadium steel
- Mat chrome finish

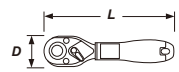

Teeth	D mm	L mm	Code	g
36	31	137	137	364

## 16132-08

### Swivel Stubby Ratchet Handle

3/8"

72T

- DIN 3122 ISO 3315
- Chrome vanadium steel
- Mat chrome finish

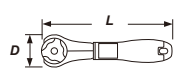

Teeth	D mm	L mm	Code	g
72	43	165	72	364

# HAND SOCKETS AND ACCESSORIES

## 16132-20

### Adjustable Ratchet Handle $\frac{3}{8}$ " 72T

- Chrome vanadium steel
- Driver head :Chrome molybdenum alloy steel
- Satin chrome finish

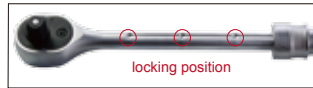

Teeth	D mm	H mm	Position	Extend range mm	Code	g
72	31	26	4	220-320	72	258

## 16132-04

### Swivel Handle $\frac{3}{8}$ "

- DIN 3122 ISO 3315
- Chrome vanadium steel
- Mat chrome finish

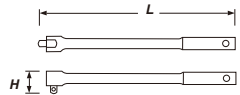
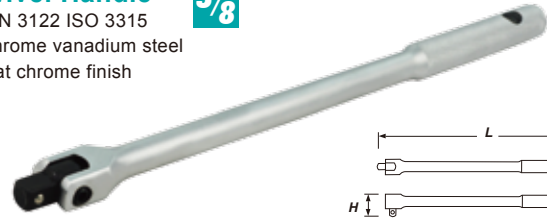

H mm	L mm	Code	g
28	200	200	160
28	250	250	210

### Repair Kit



Code

Repair kit	3T
------------	----

## 16132-05

### Flexible Handle $\frac{3}{8}$ "

- DIN 3122, ISO3315
- Chrome vanadium steel
- Mirror chrome finish

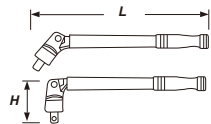
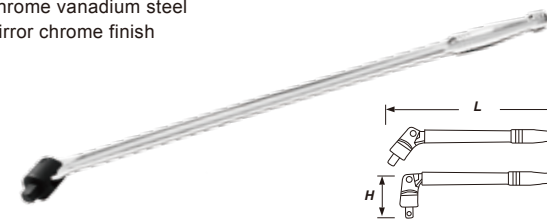

H mm	L mm	Code	g
47	300	300	470
47	375	375	963

### Repair Kit



Code

Repair kit	3T
------------	----

## 16133-01

### Wobble Extension Bar $\frac{3}{8}$ "

- DIN 3123 ISO 3316
- Chrome vanadium steel
- Mat chrome finish

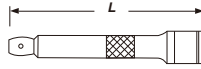
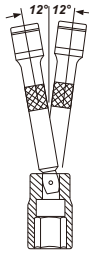

L mm	Code	g
43	043	45
75	075	80
150	150	140
200	200	190
250	250	230

## 16133-02

### Extension Bar $\frac{3}{8}$ "

- DIN 3123 ISO 3316
- Chrome vanadium steel
- Mat chrome finish



L mm	Code	g
43	043	45
75	075	75
125	125	95
150	150	140
250	250	185
450	450	306

## 16133-06

### Flexible Extension Bar $\frac{3}{8}$ "

- Chrome vanadium steel
- Mirror chrome plated



L mm	Code	g
193	193	280

## 16133-04

### Quick Release Extension Bar $\frac{3}{8}$ "

- DIN 3123 ISO 3316
- Chrome vanadium steel
- Lock system prevents socket loss
- Mat chrome finish

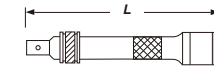

L mm	Code	g
75	075	75
150	150	150
250	250	250

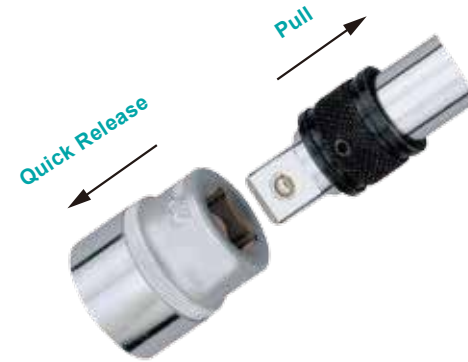

## 16134-01

### Sliding T Bar $\frac{3}{8}$ "

- DIN 3122 ISO 3315
- Chrome vanadium steel
- Mat chrome finish

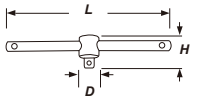
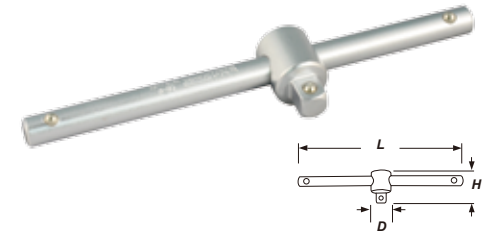

H mm	L mm	Code	g
21.5	165	165	155
21.5	200	200	160

## 16134-02

### Speedy Driver $\frac{3}{8}$ "

- DIN 3122 ISO 3315
- Chrome vanadium steel
- Mat chrome finish

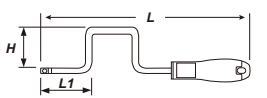

H mm	L mm	L1 mm	Code	g
90	390	95	390	418

## 16135-01

### Universal Joint $\frac{3}{8}$ "

- DIN 3123 ISO 3316
- Chrome vanadium steel
- Mat chrome finish

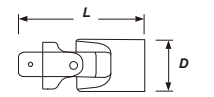

D mm	L mm	Code	g
18	55	055	51

# HAND SOCKETS AND ACCESSORIES

## 16135-04

### Adapter

3/8"

- DIN 3123 ISO 3316
- Chrome vanadium steel
- Mat chrome finish

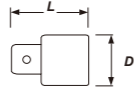

Size	D mm	L mm	Code	g
1/4" x 3/8"	19	26	1438	20
1/2" x 3/8"	19	36	1238	45

## 16135-05

### 3-Way Adapter

3/8"

- DIN 3123 ISO 3316
- Chrome vanadium steel
- Mat chrome finish

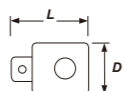

Size	D mm	L mm	Code	g
1/4" x 3/8"	19	29	1438	32
1/2" x 3/8"	24	44	1238	70

## 16135-06

### Coupler

3/8"

- DIN 3124 ISO 2725
- Chrome vanadium steel
- Mat chrome finish



Hex. x DR.	L mm	Code	g
1/4" x 3/8"	30	1438	18
5/16" x 3/8"	30	51638	25
10mm x 3/8"	30	1038	25

## 16135-07

### Adapter

3/8"

- Chrome vanadium steel
- Mat chrome finish

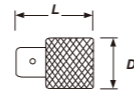

Size	D mm	L mm	Code	g
1/2" x 3/8"	30	25	3812	54

## 16137-11

### Bit Sockets, SL

3/8"

- DIN ISO 2380-1, DIN 3120
- Socket double finish
- Chrome vanadium steel
- Bit silicon alloy steel (S2)

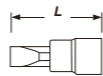

⊖ ⊕	a x b	L mm	Code	g
	0.8 4.0	48	048040	35
	0.8 4.5	48	048045	35
	1.0 5.5	48	048055	35
	1.2 6.5	48	048065	35
	1.2 8.0	48	048080	35
	1.6 10	48	048100	35

## 16137-21

### Bit Sockets, PH

3/8"

- DIN ISO 8764-1, DIN 3120
- Socket double finish
- Chrome vanadium steel
- Bit silicon alloy steel (S2)

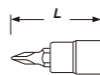

⊕	L mm	Code	g
1	48	0481	35
2	48	0482	35
3	48	0483	35
4	48	0484	35

## 16137-31

### Bit Sockets, PZ

3/8"

- DIN ISO 8764-1, DIN 3120
- Socket double finish
- Chrome vanadium steel
- Bit silicon alloy steel (S2)

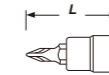

⊕	L mm	Code	g
1	48	0480	35
2	48	0481	35
3	48	0482	35
4	48	0483	35

## 16137-41

### Bit Sockets, TX

3/8"

- DIN 3120
- Sockets double finish
- Chrome vanadium steel
- Bit silicon alloy steel (S2)

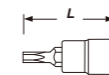

⊕	L mm	Code	g
8	48	04808	35
10	48	04810	35
15	48	04815	35
20	48	04820	35
25	48	04825	35
27	48	04827	35
30	48	04830	35
40	48	04840	35
45	48	04845	35
50	48	04850	35
55	48	04855	35

## 16137-44

### Bit Socket, TP (Ribe)

3/8"

- DIN 3120
- Socket double finish
- Chrome vanadium steel
- Bit silicon alloy steel (S2)

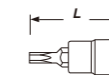

⊕	L mm	Code	g
7	48	04807	50
10	48	04810	55
5	100	10005	58
6	100	10006	60
7	100	10007	63
8	100	10008	64
9	100	10009	81
10	100	10010	83

## 16137-51

### Bit Socket, TX Tamper-Proof

3/8"

- DIN 3120
- Socket double finish
- Chrome vanadium steel
- Bit silicon alloy steel (S2)

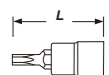

⊕	L mm	Code	g
8	48	04808	35
10	48	04810	35
15	48	04815	35
20	48	04820	35
25	48	04825	35
27	48	04827	35
30	48	04830	35
40	48	04840	35
45	48	04845	35
50	48	04850	35
55	48	04855	35

## 16137-53

### Bit Socket, TS (Five-sided)

3/8"

- DIN 3120
- Socket double finish
- Chrome vanadium steel
- Bit silicon alloy steel (S2)

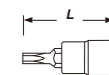

⊕	L mm	Code	g
45	48	04845	40
50	48	04850	45

## 16137-61

### Bit Socket, HX

3/8"

- DIN 7422, DIN 3120
- Sockets double finish
- Chrome vanadium steel
- Bit silicon alloy steel (S2)

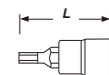

⬠	L mm	Code	g
3.0	48	048030	35
4.0	48	048040	35
5.0	48	048050	35
5.5	48	048055	35
6.0	48	048060	35
7.0	48	048070	39
8.0	48	048080	42
9.0	48	048090	44
10.0	48	048100	47



# HAND SOCKETS AND ACCESSORIES

## 16138-1

### Spark Plug Sockets, 6-Point $\frac{3}{8}$ "

- Chrome vanadium steel
- Mirror and mat chrome finish

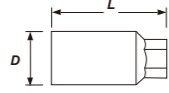

Size	D mm	L mm	Code	g
16	22	65	16	96
18	26	67	18	142
21	28	67	21	146

## 16138-2

### Deep Spark Plug Sockets, 12-Point $\frac{3}{8}$ "

- Chrome vanadium steel
- Mirror chrome finish

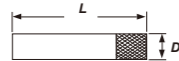

Size	D mm	L mm	Code	g
14	20	90	090	90
14	19	250	250	322
14	19	300	300	392

## 16138-3

### Universal Deep Spark Plug Sockets, 12-point $\frac{3}{8}$ "

- Chrome vanadium steel
- Mirror chrome finish

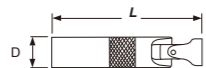
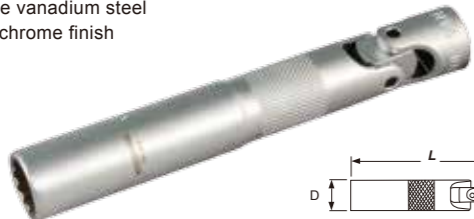

Size	D mm	L mm	Code	g
14	20	135	145	182
14	19	250	275	335

## 12733-1

### Spark Plug Sockets, 12-Point $\frac{3}{8}$ "

- Chrome vanadium steel
- Mirror chrome finish

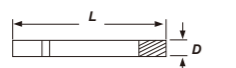
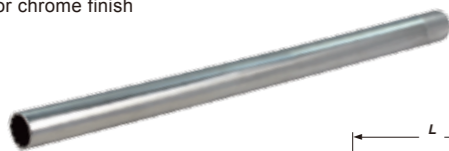

Size	D mm	L mm	Code	g
14	20	90	090	90
14	19	250	250	322
14	19	300	300	392

## 12733-2

### Universal Spark Plug Sockets, 12-Point $\frac{3}{8}$ "

- Chrome vanadium steel
- Mirror chrome finish

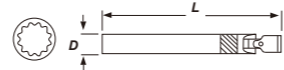

Size	D mm	L mm	Code	g
14	20	135	145	182
14	19	250	275	335

## 12733-3

### Wobble T Handle

- Chrome vanadium steel
- Mirror chrome finish

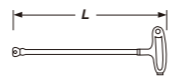

Size	L mm	Code	g
$\frac{3}{8}$ "	290	290	243

## 12733-5

### Spark Plug Sockets $\frac{3}{8}$ "

- Chrome vanadium steel
- Mirror and mat chrome finish

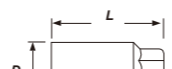

Size	D mm	L mm	Code	g
16	22	65	160	96
18	26	67	180	142
21	28	67	210	146
$\frac{5}{8}$ "	22	65	058	96
$\frac{13}{16}$ "	28	65	1316	140

## 16141-11

### Sockets, 6-Point $\frac{1}{2}$ "

- DIN 3124 ISO 2725
- Chrome vanadium steel
- Mat chrome finish



Size	D1 mm	D2 mm	L mm	Code	g
8	13.0	21.8	38	080S	49
9	14.3	21.8	38	090S	49
10	15.3	21.8	38	100S	49
11	16.6	21.8	38	110S	50
12	17.6	21.8	38	120S	50
13	19.1	21.8	38	130S	51
14	20.3	21.8	38	140S	53
15	21.7	21.8	38	150S	53
16	21.8	21.8	38	160S	53
17	23.8	22.0	38	170S	60
18	25.5	24.0	38	180S	70
19	25.7	22.9	38	190S	70
20	27.8	25.0	38	200S	78
21	27.8	26.0	38	210S	78
22	29.9	26.0	38	220S	90
23	31.8	27.0	38	230S	106
24	31.8	27.8	40	240S	110
25	33.8	30.0	42	250S	115
26	33.8	30.0	42	260S	130
27	35.8	31.0	42	270S	150
28	37.8	32.0	42	280S	160
29	37.8	33.0	42	290S	180
30	39.9	34.0	45	300S	193
32	41.8	35.8	45	320S	219
34	41.8	35.8	45	340S	234

## 16141-12

### Deep Sockets, 6-Point $\frac{1}{2}$ "

- DIN 3124 ISO 2725
- Chrome vanadium steel
- Mat chrome finish

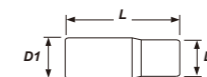

Size	D1 mm	D2 mm	L mm	Code	g
8	13.0	21.8	77	080S	90
9	14.3	21.8	77	090S	90
10	15.3	21.8	77	100S	90
11	16.6	21.8	77	110S	90
12	17.6	21.8	77	120S	90
13	19.1	21.8	77	130S	90
14	20.3	21.8	77	140S	104
15	21.7	21.8	77	150S	104
16	21.8	21.8	77	160S	104
17	23.8	22.0	77	170S	120
18	25.5	24.0	77	180S	149
19	25.7	24.0	77	190S	134
20	27.8	25.0	77	200S	162
21	27.8	26.0	77	210S	158
22	29.9	26.0	77	220S	184
24	31.8	27.8	77	240S	210
27	35.8	31.0	77	270S	236
30	39.9	34.0	77	300S	305
32	41.8	35.8	77	320S	336

## 16141-21

### SAE Sockets, 6-Point $\frac{1}{2}$ "

- Chrome vanadium steel
- Mirror chrome finish

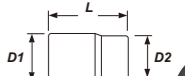

Size	D1 mm	D2 mm	L mm	Code	g
$\frac{5}{16}$ "	13.0	21.8	38	1032	49
$\frac{3}{8}$ "	14.3	21.8	38	1232	49
$\frac{7}{16}$ "	16.6	21.8	38	1432	50
$\frac{15}{32}$ "	17.6	21.8	38	1532	50
$\frac{1}{2}$ "	19.1	21.8	38	1632	51
$\frac{9}{16}$ "	20.3	21.8	38	1832	53
$\frac{19}{32}$ "	21.7	21.8	38	1932	53
$\frac{5}{8}$ "	21.8	21.8	38	2032	53
$\frac{21}{32}$ "	23.8	22.0	38	2132	72
$\frac{11}{16}$ "	23.8	22.0	38	2232	60
$\frac{3}{4}$ "	25.7	22.9	38	2432	78
$\frac{25}{32}$ "	27.8	25.0	38	2532	78
$\frac{13}{16}$ "	27.8	26.0	38	2632	78
$\frac{7}{8}$ "	29.9	26.0	38	2832	99
$\frac{15}{16}$ "	31.8	27.8	40	3032	110
1"	33.8	30.0	42	3232	115
1"- $\frac{1}{16}$ "	35.8	31.0	42	3432	150
1"- $\frac{1}{8}$ "	37.8	33.0	42	3632	180
1"- $\frac{3}{16}$ "	39.9	34.0	45	3832	193
1"- $\frac{1}{4}$ "	41.8	35.8	45	4032	219

## 16141-22

### SAE Deep Sockets, 6-Point $\frac{1}{2}$ "

- Chrome vanadium steel
- Mirror chrome finish



Size	D1 mm	D2 mm	L mm	Code	g
$\frac{3}{8}$ "	15.3	21.8	77	1232	90
$\frac{7}{16}$ "	16.6	21.8	77	1432	90
$\frac{1}{2}$ "	19.1	21.8	77	1632	90
$\frac{9}{16}$ "	20.3	21.8	77	1832	104
$\frac{19}{32}$ "	21.7	21.8	77	1932	104
$\frac{5}{8}$ "	21.8	21.8	77	2032	104
$\frac{11}{16}$ "	23.8	22.0	77	2232	120
$\frac{3}{4}$ "	25.7	24.0	77	2432	134
$\frac{13}{16}$ "	27.8	26.0	77	2632	158
$\frac{7}{8}$ "	29.9	26.0	77	2832	184
$\frac{15}{16}$ "	31.8	27.8	77	3032	210
1"	33.8	30.0	77	3232	225
1"- $\frac{1}{16}$ "	35.8	31.0	77	3432	236

# HAND SOCKETS AND ACCESSORIES

## 16141-31

- Torks Sockets** 1/2"
- Chrome vanadium steel
  - Mirror and mat chrome finish

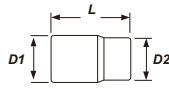

Size	D1 mm	D2 mm	L mm	Code	g
E8	11.6	22.0	38	080	48
E10	13.5	22.0	38	100	48
E11	14.3	22.0	38	110	50
E12	15.0	22.0	38	120	50
E14	16.4	22.0	38	140	53
E16	19.0	22.0	38	160	56
E18	24.0	22.1	38	180	77
E20	25.9	24.0	38	200	90
E22	25.9	24.1	38	220	84
E24	28.0	24.1	38	240	88

## 16141-32

- Torks Deep Sockets** 1/2"
- Chrome vanadium steel
  - Mirror and mat chrome finish

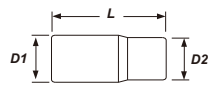

Size	D1 mm	D2 mm	L mm	Code	g
E10	13.5	22.0	77	100	96
E11	14.3	22.0	77	110	96
E12	15.0	22.0	77	120	103
E14	16.4	22.0	77	140	107
E16	19.0	22.0	77	160	123
E18	24.0	22.1	77	180	141
E20	25.9	24.0	77	200	164
E24	28.0	24.1	77	240	202

## 16141-41

- Socket, 12-Point** 1/2"
- DIN 3124 ISO 2725
  - Chrome vanadium steel
  - Mat chrome finish

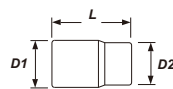

Size	D1 mm	D2 mm	L mm	Code	g
8	13.0	21.8	38	080S	49
9	14.3	21.8	38	090S	49
10	15.3	21.8	38	100S	49
11	16.6	21.8	38	110S	50
12	17.6	21.8	38	120S	50
13	19.1	21.8	38	130S	51
14	20.3	21.8	38	140S	53
15	21.7	21.8	38	150S	53
16	21.8	21.8	38	160S	53
17	23.8	22.0	38	170S	60
18	25.5	24.0	38	180S	70
19	25.7	22.9	38	190S	70
20	27.8	25.0	38	200S	78
21	27.8	26.0	38	210S	78
22	29.9	26.0	38	220S	90
23	31.8	27.0	38	230S	106
24	31.8	27.8	40	240S	110
25	33.8	30.0	42	250S	115
26	33.8	30.0	42	260S	130
27	35.8	31.0	42	270S	150
28	37.8	32.0	42	280S	160
29	37.8	33.0	42	290S	180
30	39.9	34.0	45	300S	193
32	41.8	35.8	45	320S	219
34	41.8	35.8	45	340S	234

## 16142-01

- Ratchet Handle** 1/2" 45T
- DIN 3122 ISO 3315
  - Chrome vanadium steel
  - Mirror chrome finish

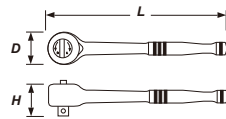
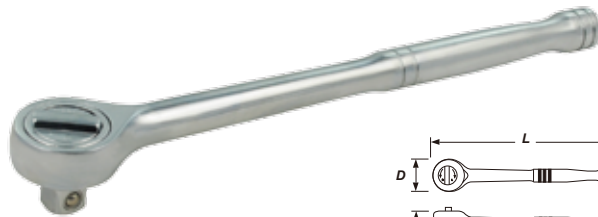

Teeth	D mm	H mm	L mm	Code	g
45	41	40	250	250	550

## 16141-51

- SAE Socket, 12-Point** 1/2"
- Chrome vanadium steel
  - Mirror chrome finish

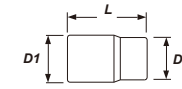

Size	D1 mm	D2 mm	L mm	Code	g
5/16"	13.0	21.8	38	1032	49
3/8"	14.3	21.8	38	1232	49
7/16"	16.6	21.8	38	1432	50
15/32"	17.6	21.8	38	1532	50
1/2"	19.1	21.8	38	1632	51
9/16"	20.3	21.8	38	1832	53
19/32"	21.7	21.8	38	1932	53
5/8"	21.8	21.8	38	2032	53
21/32"	23.8	22.0	38	2132	72
11/16"	23.8	22.0	38	2232	60
3/4"	25.7	22.9	38	2432	78
25/32"	27.8	25.0	38	2532	78
13/16"	27.8	26.0	38	2632	78
7/8"	29.9	26.0	38	2832	99
15/16"	31.8	27.8	40	3032	110
1"	33.8	30.0	42	3232	115
1-1/16"	35.8	31.0	42	3432	150
1-1/8"	37.8	33.0	42	3632	180
1-3/16"	39.9	34.0	45	3832	193
1-1/4"	41.8	35.8	45	4032	219

## 16142-02

- Ratchet Handle, Straight** 1/2" 36T 72T
- DIN 3122 ISO 3315
  - Chrome vanadium steel
  - Mat chrome finish

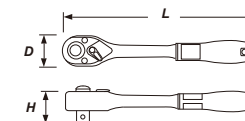

Teeth	D mm	H mm	L mm	Code	g
36	40	38	260	36	547
72	40	38	260	72	547

### Repair Kit



Teeth	Code
36	36T
72	72T

## 16142-03

- Ratchet Handle, Curved** 1/2" 36T 72T
- DIN 3122 ISO 3315
  - Chrome vanadium steel
  - Mat chrome finish

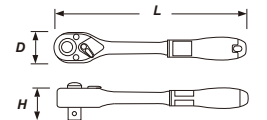

Teeth	D mm	H mm	L mm	Code	g
36	40	38	260	36	547
72	40	38	260	72	547

### Repair Kit



Teeth	Code
36	36T
72	72T

## 16142-06

- Swivel Ratchet Handle** 1/2" 72T
- DIN 3122 ISO 3315
  - Chrome vanadium steel
  - Mat chrome finish



Teeth	D mm	L mm	Code	g
72	49	300	72	650

# HAND SOCKETS AND ACCESSORIES

## 16142-10

### Swivel Stubby Ratchet Handle $\frac{1}{2}$ " 72T

- DIN 3122 ISO 3315
- Chrome vanadium steel
- Mat chrome finish

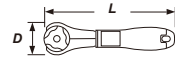

Teeth	D mm	L mm	Code	g
72	44	168	72	364

## 16142-09

### Ratchet Handle, Go-Thru Type $\frac{1}{2}$ " 72T

- Chrome vanadium steel
- Mat chrome finish



Teeth	D mm	L mm	Code	g
72	43	270	270	510

### Square Driver $\frac{1}{2}$ "

- Chrome vanadium steel
- Mat chrome finish

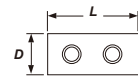

L mm	Code	g
38	38	40



## 16142-20

### Adjustable Ratchet Handle $\frac{1}{2}$ " 72T

- Chrome vanadium steel
- Driver head :Chrome molybdenum alloy steel
- Satin chrome finish

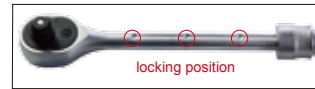

Teeth	D mm	H mm	Position	Extend range mm	Code	g
72	40	38	6	305-445	72	567

## 16142-04

### Swivel Handle $\frac{1}{2}$ "

- DIN 3122 ISO3315
- Chrome vanadium steel
- Mat chrome finish

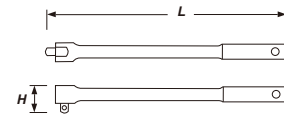

H mm	L mm	Code	g
37	375	375	785
37	450	450	880

## 16142-11

### Swivel Handle $\frac{1}{2}$ "

- DIN 3122 ISO3315
- Chrome vanadium steel
- Mat chrome finish

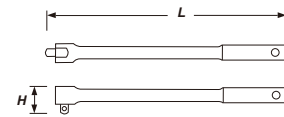

H mm	L mm	Code	g
37	385	385	805

### Repair Kit



Repair kit	Code
	3T

## 16142-05

### Flexible Handle $\frac{1}{2}$ "

- DIN 3122 ISO 3315
- Heavy duty model
- Chrome vanadium steel
- Mirror chrome finish

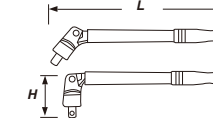
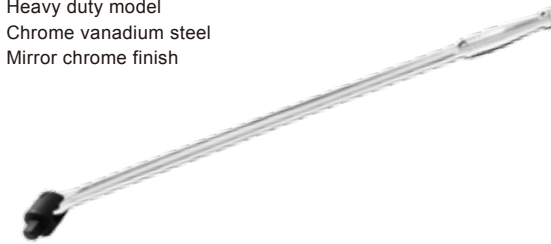

H mm	L mm	Code	g
55	300	300	622
55	600	600	1400

### Repair Kit



Repair kit	Code
	3T

## 16143-01

### Wobble Extension Bar $\frac{1}{2}$ "

- DIN 3123 ISO 3316
- Square driver round profile gives working angle of 12°
- Chrome vanadium steel
- Mat chrome finish

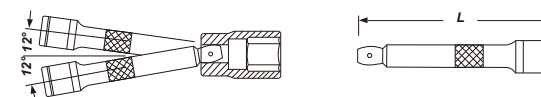

L mm	Code	g
50	050	97
75	075	138
125	125	222
150	150	260
200	200	346
250	250	428
375	375	490
450	450	525
600	600	697

## 16143-02

### Extension Bar $\frac{1}{2}$ "

- DIN 3123 ISO 3316
- Chrome vanadium steel
- Satin chrome finish

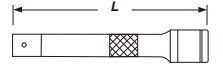

L mm	Code	g
50	050	97
75	075	138
125	125	222
150	150	260
200	200	346
250	250	428
375	375	490
450	450	525
600	600	697

# HAND SOCKETS AND ACCESSORIES

## 16143-04

### Quick Release Extension Bar $\frac{1}{2}$ "

- DIN 3123 ISO 3316
- Chrome vanadium steel
- Mat chrome finish



L mm	Code	g
75	075	146
125	125	235
250	250	441

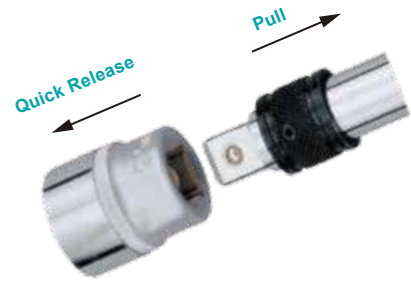

## 16143-07

### Flexible Extension Bar $\frac{1}{2}$ "

- Chrome vanadium steel
- Mirror chrome plated



L mm	Code	g
205	205	285

## 16144-01

### Sliding T Bar $\frac{1}{2}$ "

- DIN 3122 ISO 3315
- Chrome vanadium steel
- Mat chrome finish



D mm	H mm	L mm	Code	g
24	26	250	250	365
24	26	300	300	415

## 16144-02

### L Handle $\frac{1}{2}$ "

- Chrome vanadium steel
- Mat chrome finish

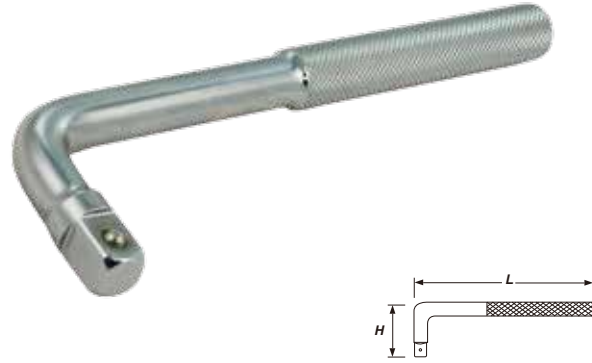

H mm	L mm	Code	g
60	200	200	332

## 16144-03

### L Double Driver $\frac{1}{2}$ "

- Chrome vanadium steel
- Mat chrome finish

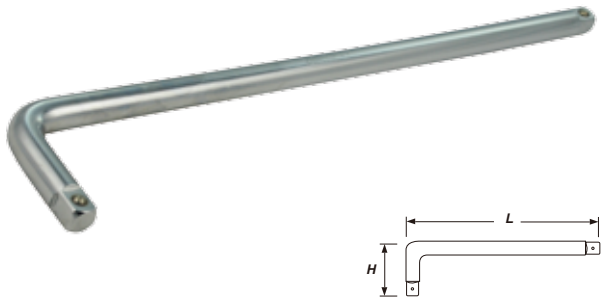

H mm	L mm	Code	g
75	285	300	550

## 16144-04

### Speedy Driver $\frac{1}{2}$ "

- DIN 3122 ISO 3315
- Chrome vanadium steel
- Mat chrome finish

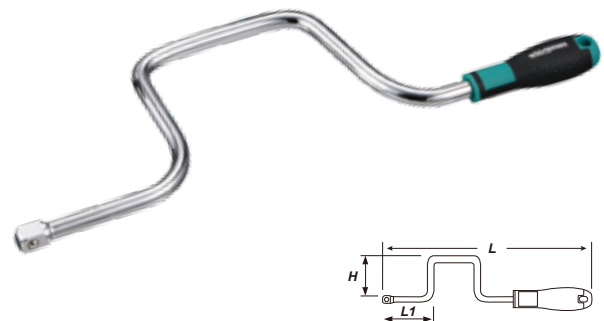

H mm	L mm	L1 mm	Code	g
120	395	110	395	560

## 16145-02

### Universal Joint $\frac{1}{2}$ "

- DIN 3123 ISO 3316
- Chrome vanadium steel
- Mat chrome finish



D mm	L mm	Code	g
25	78	078	155

## 16145-03

### Adapter $\frac{1}{2}$ "

- DIN 3123 ISO 3316
- Chrome vanadium steel
- Mat chrome finish



Size	D mm	L mm	Code	g
3/8" x 1/2" □	22	36	3812	51
3/4" x 1/2" □	26	48	3412	115

## 16145-04

### 3-Way Adapter $\frac{1}{2}$ "

- DIN 3123 ISO 3316
- Chrome vanadium steel
- Mat chrome finish

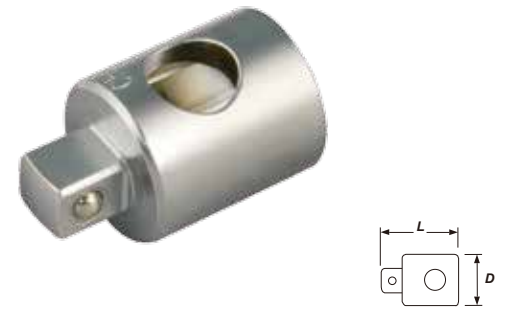

Size	D mm	L mm	Code	g
3/8" x 1/2" □	24	44	3812	70

## 16145-05

### Coupler $\frac{1}{2}$ "

- DIN 3124 ISO 2725
- Chrome vanadium steel
- Mat chrome finish



Hex. x DR.	L mm	Code	g
1/4" x 1/2"	38	1412	40
5/16" x 1/2"	38	51612	42
10mm x 1/2"	38	1012	50

## 16147-11

### Bit Socket, SL $\frac{1}{2}$ "

- DIN ISO 2380-1, DIN 3120
- Socket double finish
- Chrome vanadium steel
- Bit silicon alloy steel (S2)

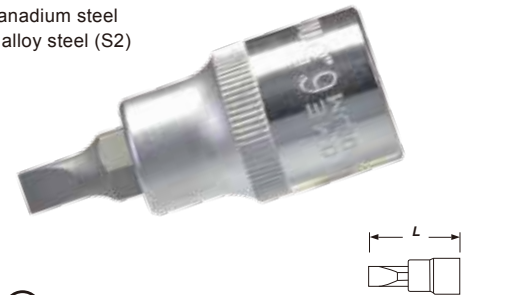

a x b	L mm	Code	g
1.2 8.0	55	05508	70
1.6 10.0	55	05510	70
2.0 12.0	55	05512	92
2.5 14.0	55	05514	112
2.5 16.0	55	05516	112

## 16147-21

### Bit Sockets, PH $\frac{1}{2}$ "

- DIN ISO 8764-1, DIN 3120
- Socket double finish
- Chrome vanadium steel
- Bit silicon alloy steel (S2)

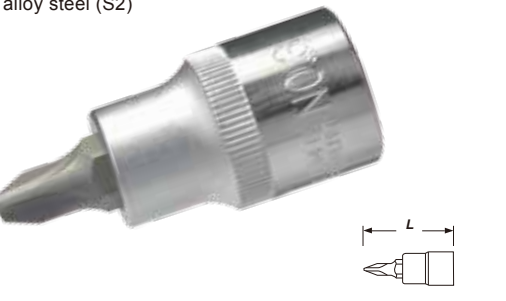

Size	L mm	Code	g
2	55	0552	65
3	55	0553	65
4	55	0554	70

## 16147-41

### Bit Socket, TX $\frac{1}{2}$ "

- DIN 3120
- Socket double finish
- Chrome vanadium steel
- Bit silicon alloy steel (S2)

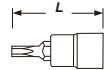

✳	L mm	Code	g
15	55	05515	85
20	55	05520	85
25	55	05525	85
27	55	05527	85
30	55	05530	85
40	55	05540	85
45	55	05545	85
50	55	05550	85
55	55	05555	87
60	55	05560	95
70	55	05570	99
20	100	10020	122
25	100	10025	122
27	100	10027	122
30	100	10030	122
40	100	10040	122
45	100	10045	122
50	100	10050	122
55	100	10055	122
60	100	10060	122
70	100	10070	122
15	140	14015	143
20	140	14020	143
25	140	14025	143
27	140	14027	143
30	140	14030	143
40	140	14040	143
45	140	14045	143
50	140	14050	143
55	140	14055	143
60	140	14060	143
70	140	14070	170

## 16147-31

### Bit Socket, PZ $\frac{1}{2}$ "

- DIN ISO 8764-1, DIN 3120
- Socket double finish
- Chrome vanadium steel
- Bit silicon alloy steel (S2)

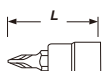

✳	L mm	Code	g
2	55	0552	65
3	55	0553	65
4	55	0554	70

## 16147-44

### Bit Socket, TP (Ribe) $\frac{1}{2}$ "

- DIN 3120
- Socket double finish
- Chrome vanadium steel
- Bit silicon alloy steel (S2)

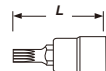

✳	L mm	Code	g
5	55	05505	85
6	55	05506	85
7	55	05507	85
8	55	05508	85
9	55	05509	85
10	55	05510	85
12	55	05512	85
13	55	05513	85
14	55	05514	85
5	100	10005	122
6	100	10006	122
7	100	10007	122
8	100	10008	122
9	100	10009	122
10	100	10010	122
12	100	10012	122
13	100	10013	122
14	100	10014	122

## 16147-81

### Bit Socket, SP $\frac{1}{2}$ "

- DIN 3120
- Socket double finish
- Chrome vanadium steel
- Bit silicon alloy steel (S2)

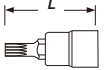
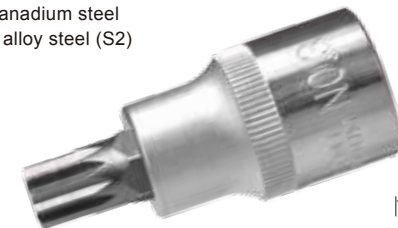

✳	L mm	Code	g
5	55	05505	67
6	55	05506	67
8	55	05508	67
10	55	05510	88
12	55	05512	100
14	55	05514	131
16	55	05516	162
6	100	10006	85
8	100	10008	87
10	100	10010	110
12	100	10012	151
14	100	10014	187
16	100	10016	242
8	140	14008	120
10	140	14010	140
12	140	14012	185

## 16147-51

### Bit Socket, TX Tamper-Proof $\frac{1}{2}$ "

- DIN 3120
- Socket double finish
- Chrome vanadium steel
- Bit silicon alloy steel (S2)

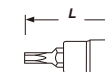

✳	L mm	Code	g
20	55	05520	85
25	55	05525	85
27	55	05527	85
30	55	05530	85
40	55	05540	85
45	55	05545	85
50	55	05550	85
55	55	05555	87
60	55	05560	95
70	55	05570	99
20	100	10020	122
25	100	10025	122
27	100	10027	122
30	100	10030	122
40	100	10040	122
45	100	10045	122
50	100	10050	122
55	100	10055	122
60	100	10060	122
70	100	10070	122

## 16147-83

### Bit Socket, SPH $\frac{1}{2}$ "

- DIN 3120
- Socket double finish
- Chrome vanadium steel
- Bit silicon alloy steel (S2)

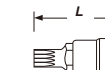

✳	L mm	Code	g
16	55	05516	162
16	100	10016	240

## 16147-61

### Bit Socket, HX $\frac{1}{2}$ "

- DIN 7422, DIN 3120
- Socket double finish
- Chrome vanadium steel
- Bit silicon alloy steel (S2)

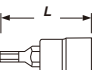

✳	L mm	Code	g
4	55	05504	85
5	55	05505	85
6	55	05506	85
7	55	05507	85
8	55	05508	85
9	55	05509	88
10	55	05510	88
12	55	05512	99
14	55	05514	134
17	55	05517	146
19	55	05519	157
5	100	10005	122
6	100	10006	122
7	100	10007	122
8	100	10008	122
10	100	10010	122
11	100	10011	122
12	100	10012	122
13	100	10013	122
14	100	10014	157
17	100	10017	170
19	100	10019	180
5	140	14005	143
6	140	14006	143
7	140	14007	143
8	140	14008	143
10	140	14010	143
11	140	14011	143
13	140	14013	143
14	140	14014	143
3/16"	55	055316	85
7/32"	55	055732	85
1/4"	55	055416	85
5/16"	55	055516	85
3/8"	55	055616	85
7/16"	55	055716	88
1/2"	55	055816	88
9/16"	55	055916	99
5/8"	55	0551016	134
3/4"	55	0551216	146

# HAND SOCKETS AND ACCESSORIES

## 16148-1

### Spark Plug Socket, 6-POINT 1/2"

- Chrome vanadium steel
- Mirror and mat chrome finish

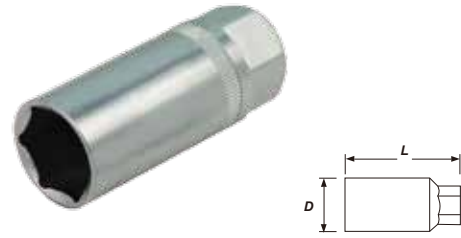

Size	D mm	L mm	Code	g
16	22	65	16	97
21	28	67	21	146

## 12743-4

### Flexible Extension Spark Plug Sockets 1/2"

- Chrome vanadium steel
- Mirror and mat chrome finish

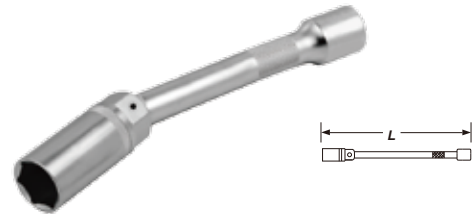

Size	L mm	Code	g
16	207	207	260
21	210	210	315

## 12743-5

### Spark Plug Sockets 1/2"

- Chrome vanadium steel
- Mirror and mat chrome finish



Size	D mm	L mm	Code	g
16	22	65	160	96
18	26	67	180	142
21	28	67	210	146
5/8"	22	65	058	96
13/16"	28	65	1316	140

## 16161-11

### Socket, 6-Point 3/4"

- DIN 3124 ISO 2725
- Chrome vanadium steel
- Mirror and mat chrome finish

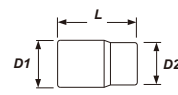

Size	D1 mm	D2 mm	L mm	Code	g
19	29	33	50	190	165
21	31	33	50	210	165
22	32	36	50	220	215
23	33	36	50	230	220
24	34	36	51	240	225
26	38	36	52	260	225
27	38	36	52	270	225
28	40	38	52	280	265
29	40	38	52	290	255
30	42	38	54	300	285
32	44	38	56	320	305
33	46	38	56	330	330
34	46	38	56	340	320
35	48	42	58	350	390
36	50	42	58	360	425
37	52	45	60	370	510
38	52	45	60	380	490
39	54	45	62	390	540
41	56	45	64	410	560
42	57	45	64	420	565
43	58	46	65	430	590
44	60	47	66	440	610
45	60	47	66	450	600
46	62	47	68	460	660
47	64	48	70	470	700
48	64	48	70	480	710
50	68	48	72	500	815
51	70	48	72	510	915
52	70	48	72	520	910
54	72	48	74	540	940
55	74	48	76	550	1050
56	76	48	76	560	1100
57	76	48	76	570	1040
58	78	48	78	580	1050
60	80	48	78	600	1100
63	84	50	80	630	1250
65	86	50	82	650	1200

## 16161-21

### SAE Socket, 12-Point 3/4"

- Chrome vanadium steel
- Mirror chrome finish

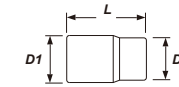

Size	D1 mm	D2 mm	L mm	Code	g
3/4"	29	33	50	2432	165
13/16"	31	33	50	2632	165
7/8"	32	36	50	2832	215
15/16"	34	36	51	3032	225
1"	38	36	52	3232	225
1-1/16"	38	36	52	3432	225
1-1/8"	40	38	52	3632	255
1-3/16"	42	38	54	3832	285
1-1/4"	44	38	56	4032	305
1-5/16"	46	38	56	4232	330
1-3/8"	48	42	58	4432	390
1-7/16"	50	42	60	4632	425
1-1/2"	52	45	60	4832	490
1-5/8"	56	45	64	5032	560
1-11/16"	56	45	64	5232	555
1-3/4"	60	47	66	5432	610
1-13/16"	62	47	68	5632	660
1-7/8"	64	48	70	5832	740
2"	68	48	72	6432	815

## 16162-01

### Ratchet Handle, Push Release 3/4" 24T

- DIN 3122 ISO 3315
- Chrome vanadium steel
- Mat chrome finish

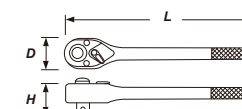

Teeth	D mm	H mm	L mm	Code	g
24	62	58	510	510	2695

## 16161-41

### Socket, 12-Point 3/4"

- DIN 3124 ISO 2725
- Chrome vanadium steel
- Mirror and mat chrome finish

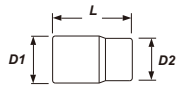

Size	D1 mm	D2 mm	L mm	Code	g
19	29	33	50	190	165
21	31	33	50	210	165
23	33	36	50	230	220
24	34	36	51	240	225
26	38	36	52	260	225
27	38	36	52	270	225
29	40	38	52	290	255
30	42	38	54	300	285
32	44	38	56	320	305
33	46	38	56	330	330
34	46	38	56	340	320
35	48	42	58	350	390
36	50	42	58	360	425
38	52	45	60	380	490
41	56	45	62	410	560
46	62	47	68	460	660
50	68	48	72	500	815
55	74	48	76	550	1050

## 16162-02

### Ratchet Handle, Push Release 3/4" 24T

- DIN 3122 ISO 3315
- Compact head with working angle of 15°
- Chrome vanadium steel
- Mat chrome finish

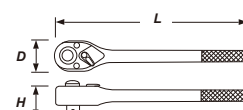

Teeth	D mm	H mm	L mm	Code	g
24	62	58	510	510	2673

# HAND SOCKETS AND ACCESSORIES

## 16162-03

### Ratchet Handle, Push Release $\frac{3}{4}$ " 24T

- DIN 3122 ISO 3315
- Chrome vanadium steel
- Mat chrome finish

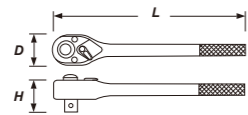

Teeth	D mm	H mm	L mm	Code	g
24	62	58	500	500	1988

## 16162-04

### Ratchet Handle $\frac{3}{4}$ " 24T

- DIN 3122 ISO 3315
- Chrome vanadium steel
- Mat chrome finish

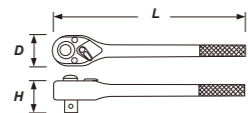

Teeth	D mm	H mm	L mm	Code	g
24	62	58	500	500	1988

## 16162-06

### Swivel Handle $\frac{3}{4}$ "

- DIN 3122 ISO 3315
- Chrome vanadium steel
- Mat chrome finish

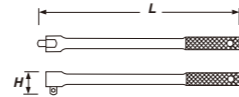

H mm	L mm	Code	g
56.5	510	510	1807

## 16162-07

### Swivel Handle with Quick Release $\frac{3}{4}$ "

- DIN 3122 ISO 3315
- Chrome vanadium steel
- Mat chrome finish

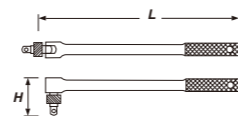

H mm	L mm	Code	g
56.5	530	530	1930

## 16163-01

### Extension Bar $\frac{3}{4}$ "

- DIN 3123 ISO 3316
- Chrome vanadium steel
- Mat chrome finish

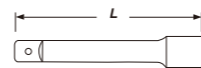

L mm	Code	g
100	100	423
200	200	805
400	400	1554

## 16163-02

### Quick Release Extension Bar $\frac{3}{4}$ "

- DIN 3123 ISO 3316
- Chrome vanadium steel
- Mat chrome finish

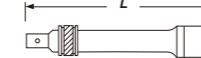

L mm	Code	g
100	100	447
200	200	841
400	400	1621

## 16164-01

### Sliding T Bar $\frac{3}{4}$ "

- DIN 3122 ISO 3315
- Chrome vanadium steel
- Mat chrome finish

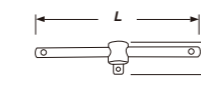

H mm	L mm	Code	g
60	460	460	1322

## 16164-02

### Sliding T Bar with Push Release $\frac{3}{4}$ "

- DIN 3122 ISO 3315
- Chrome vanadium steel
- Mat chrome finish

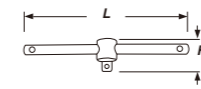

H mm	L mm	Code	g
60	460	460	1331

## 16165-01

### Universal Joint $\frac{3}{4}$ "

- DIN 3123 ISO 3316
- Chrome vanadium steel
- Mat chrome finish

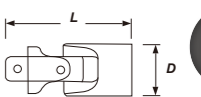

D mm	L mm	Code	g
40	100	100	508

## 16165-02

### Adapter $\frac{3}{4}$ "

- DIN 3123 ISO 3316
- Chrome vanadium steel
- Mat chrome finish

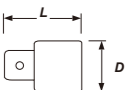

Size	D mm	L mm	Code	g
1/2" x 3/4" □	36	56	1234	225
1" x 3/4" □	36	61	1034	310

## 16164-03

### L Handle $\frac{3}{4}$ "

- Chrome vanadium steel
- Mat chrome finish

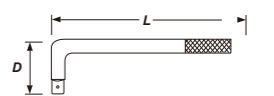
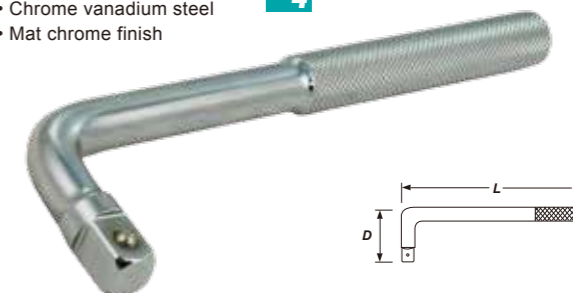

D mm	L mm	Code	g
135	450	450	1881

# HAND SOCKET SETS

## 16181-11

### Socket, 6-Point 1"

- DIN 3124 ISO 2725
- Chrome vanadium steel
- Mirror and mat chrome finish



Size	D1 mm	D2 mm	L mm	Code	g
36	51	45	65	360	490
38	54	45	65	380	540
41	57	45	70	410	590
46	65	50	75	460	870
50	70	55	75	500	1060
54	74	57	80	540	1120
55	76	57	80	550	1220
58	79	57	80	580	1300
60	82	57	84	600	1390
63	86	57	87	630	1500
65	88	57	87	650	1550
67	90	57	90	670	1700
70	94	68	93	700	1990
75	100	68	97	750	2140
77	102	68	103	770	2180
80	105	68	103	800	2240

## 16182-01

### Ratchet Handle 1"

- DIN 3122 ISO 3315
- Chrome vanadium steel
- Mat chrome finish

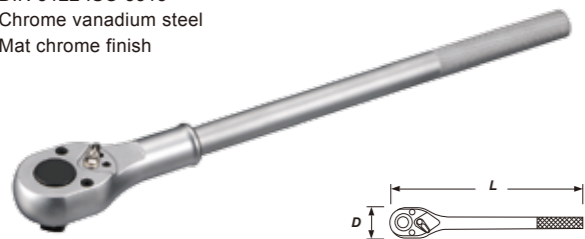

Teeth	D mm	L mm	Code	g
24	70	670	670	4400

## 16182-02

### Ratchet Handle 1"

- DIN 3122 ISO 3315
- Chrome vanadium steel
- Mat chrome finish



Teeth	D mm	L mm	Code	g
24	70	800	800	4150

## 16183-01

### Extension Bar 1"

- DIN 3123 ISO 3316
- Chrome vanadium steel
- Mat chrome finish



L mm	Code	g
200	200	1350
400	400	1570

## 16183-02

### Quick Release Extension Bar 1"

- DIN 3123 ISO 3316
- Chrome vanadium steel
- Mat chrome finish



L mm	Code	g
200	200	1400
400	400	2620

## 16184-01

### Sliding T Bar 1"

- DIN 3122 ISO 3315
- Chrome vanadium steel
- Mat chrome finish



L mm	Code	g
550	550	3210

## 16185-01

### Adapter 1"

- DIN 3123 ISO 3316
- Chrome vanadium steel
- Mat chrome finish



Size	D mm	L mm	Code	g
3/4" x 1"	48	70	3410	450

## 1273-0103

### Spark Plug Sockets Set, 3pcs 3/8"



Series	Contents	g
2 12733-5	3/8" Spark Plug Socket, (Magnetdic) 16, 21mm	587g
1 12733-3	Wobble T Handle	

## 1612-0112S

### Socket Set, 12pcs 1/4"



Series	Contents	g
12 16121-11	1/4" Sockets, 6-Point, 25mm 4, 4.5, 5, 5.5, 6, 7, 8, 9, 10, 11, 12, 13mm	190g

## 1613-0109S

### Socket Set, 9pcs 3/8"



Series	Contents	g
9 16131-11	3/8" Sockets, 6-Point 9, 10, 11, 12, 13, 14, 15, 17, 19mm	316g

## 1613-0207

### Torks Socket Set, 7pcs 3/8"



Series	Contents	g
7 16131-31	3/8" Torks Sockets, 28mm E6, E7, E8, E10, E11, E12, E14mm	215g

## 1614-0109

### Torks Socket Set, 9pcs 1/2"



Series	Contents	g
9 16141-31	1/2" Torks Sockets, 38mm E10, E11, E12, E14, E16, E18, E20, E22, E24mm	640g

## 1614-0210S

### Socket Set, 10pcs 1/2"



Series	Contents	g
10 16141-11	1/2" Sockets, 6-Point 10, 11, 12, 13, 14, 15, 17, 19, 22, 24mm	650g



# HAND SOCKET SETS

## 1612-0203

Wobble Extension Bar Set, 3pcs  $\frac{1}{4}$ "



Series	Contents	Weight
3 16123-01	1/4" Wobble Extension Bars 100, 150, 225mm	203g

## 1613-0303

Wobble Extension Bar Set, 3pcs  $\frac{3}{8}$ "



Series	Contents	Weight
3 16133-01	3/8" Wobble Extension Bars 75, 150, 200mm	325g

## 1614-0303

Wobble Extension Bar Set, 3pcs  $\frac{1}{2}$ "



Series	Contents	Weight
3 16143-01	1/2" Wobble Extension Bars 75, 150, 200mm	595g

## 1612-2612S

Socket Set, 12pcs  $\frac{1}{4}$ "



Series	Contents	Weight
12 16121-11	1/4" Sockets, 6-Point 4, 4.5, 5, 5.5, 6, 7, 8, 9, 10, 11, 12, 13mm	210g

## 1612-2712S

Deep Socket Set, 12pcs  $\frac{1}{4}$ "



Series	Contents	Weight
12 16121-12	1/4" Deep Sockets, 6-Point 4, 4.5, 5, 5.5, 6, 7, 8, 9, 10, 11, 12, 13mm	402g

## 1612-2810

Torks Socket Set, 10pcs  $\frac{1}{4}$ "



Series	Contents	Weight
5 16121-31	1/4" Torks Sockets E5, E6, E7, E8, E10	214g
5 16121-32	1/4" Torks Deep Sockets E5, E6, E7, E8, E10	

## 1612-2910

Bit Socket Set, 10pcs  $\frac{1}{4}$ "



Series	Contents	Weight
3 16127-21	1/4" Bit Sockets, PH, 32mm ⊕ 1, 2, 3	190g
7 16127-61	1/4" Bit Sockets, HX, 32mm ● 3, 4, 5, 6, 7, 8, 10	

## 1613-1510

Bit Socket, TX Set, 10pcs  $\frac{1}{4}$ "  $\frac{3}{8}$ "



Series	Contents	Weight
6 16127-41	1/4" Bit Sockets, TX, 32mm ⊕ 10, 15, 20, 25, 27, 30	265g
4 16137-41	3/8" Bit Sockets, TX, 48mm ⊕ 40, 45, 50, 55	

## 1613-1610

Torks Socket Set, 10pcs  $\frac{1}{4}$ "  $\frac{3}{8}$ "



Series	Contents	Weight
5 16121-31	1/4" Torks Sockets E4, E5, E6, E7, E8	260g
5 16131-31	3/8" Torks Sockets E10, E12, E14, E16, E18	

## 1613-1711

Bit Socket, TH Set, 11pcs  $\frac{1}{4}$ "  $\frac{3}{8}$ "



Series	Contents	Weight
8 16127-51	1/4" Bit Sockets, TH, 32mm ⊕ 8, 10, 15, 20, 25, 27, 30, 40	269g
3 16137-51	3/8" Bit Sockets, TH, 48mm ⊕ 45, 50, 55	

## 1613-1809

Bit Socket, TS (Five-sided) Set, 9pcs  $\frac{1}{4}$ "  $\frac{3}{8}$ "



Series	Contents	Weight
7 16127-52	1/4" Bit Sockets, TS, 32mm ⊕ 10, 15, 20, 25, 27, 30, 40	209g
2 16137-53	3/8" Bit Sockets, TS, 48mm ⊕ 45, 50	

## 1613-1911S

Socket Set, 11pcs  $\frac{3}{8}$ "



Series	Contents	Weight
11 16131-11	3/8" Sockets, 6-Point 8, 9, 10, 11, 12, 13, 14, 15, 16, 17, 19mm	389g

## 1613-2011S

Deep Socket set, 11pcs  $\frac{3}{8}$ "



Series	Contents	Weight
11 16131-12	3/8" Deep Sockets, 6-Point 8, 9, 10, 11, 12, 13, 14, 15, 16, 17, 19mm	913g

## 1613-2110

Torks Socket Set, 10pcs  $\frac{3}{8}$ "



Series	Contents	Weight
5 16131-31	3/8" Torks Sockets E10, E11, E12, E14, E16	560g
5 16131-32	3/8" Torks Deep Sockets E10, E11, E12, E14, E16	

## 1613-2208

Bit Socket, HX Set, 8pcs  $\frac{3}{8}$ "



Series	Contents	Weight
8 16137-61	3/8" Bit Sockets, HX, 48mm ● 4, 5, 6, 7, 8, 9, 10, 12	352g

## 1613-2307

Bit Socket Set, 7pcs  $\frac{3}{8}$ "



Series	Contents	Weight
4 16137-11	3/8" Bit Sockets, SL, 48mm ⊖ 5.5, 6.5, 8, 10	285g
3 16137-21	3/8" Bit Sockets, PH, 48mm ⊕ 1, 2, 3	

# HAND SOCKET SETS

## 1614-5914

Torks Socket Set, 14pcs

1/4" 3/8" 1/2"



Series	Contents	Weight
5 16121-31	1/4" Torks Sockets E4, E5, E6, E7, E8	583g
4 16131-31	3/8" Torks Sockets E10, E11, E12, E14	
5 16141-31	1/2" Torks Sockets E16, E18, E20, E22, E24	

## 1614-6009

Torks Socket Set, 9pcs

3/8" 1/2"



Series	Contents	Weight
4 16131-31	3/8" Torks Sockets E10, E11, E12, E14	540g
5 16141-31	1/2" Torks Sockets E16, E18, E20, E22, E24	

## 1614-6108S

Socket Set, 8pcs

1/2"



Series	Contents	Weight
8 16141-11	1/2" Sockets, 6-Point 10, 12, 13, 14, 17, 19, 21, 22mm	550g

## 1614-6212S

Socket Set, 12pcs

1/2"



Series	Contents	Weight
12 16141-11	1/2" Sockets, 6-Point 10, 11, 12, 13, 14, 15, 16, 17, 18, 19, 21, 22mm	795g

## 1614-6308S

Deep Socket Set, 8pcs

1/2"



Series	Contents	Weight
8 16141-12	1/2" Deep Sockets, 6-Point 10, 12, 13, 14, 17, 19, 21, 22mm	1.09kg

## 1614-6412S

Deep Socket Set, 12pcs

1/2"



Series	Contents	Weight
12 16141-12	1/2" Deep Sockets, 6-Point 10, 11, 12, 13, 14, 15, 16, 17, 18, 19, 21, 22mm	1.56kg

## 1614-6509

Torks Socket Set, 9pcs

1/2"



Series	Contents	Weight
9 16141-31	1/2" Torks Sockets E10, E11, E12, E14, E16, E18, E20, E22, E24	615g

## 1614-6609

Bit Socket, TP (Ribe) Set, 9pcs

1/2"



Series	Contents	Weight
9 16147-44	1/2" Bit Sockets, TP, 55mm 5, 6, 7, 8, 9, 10, 12, 13, 14	885g

## 1614-6707

Bit Socket Set, 7pcs

1/2"



Series	Contents	Weight
4 16147-11	1/2" Bit Sockets, SL, 55mm 5.5, 6.5, 8, 10	508g
3 16147-21	1/2" Bit Sockets, PH, 55mm 2, 3, 4	

## 1614-7809

Bit Socket Set, 9pcs

1/2"



Series	Contents	Weight
9 16147-61	1/2" Bit Sockets, HX, 55mm 5, 6, 7, 8, 9, 10, 12, 14, 17	508g

## 1614-7909

Bit Socket Set, 9pcs

1/2"



Series	Contents	Weight
9 16147-41	1/2" Bit Sockets, TX, 55mm 20, 25, 27, 30, 40, 45, 50, 55, 60	508g

## 1614-8007

Bit Socket Set, 7pcs

1/2"



Series	Contents	Weight
7 16147-81	1/2" Bit Sockets, SP, 55mm 5, 6, 8, 10, 12, 14, 16	508g

## 1612-1542S

Socket Set, 42pcs

1/4" 36T



Series	Contents	Weight
20	1/4" Bits, 25mm	
961-11	4, 5.5, 6.5	
962-11	1, 2, 3	
963-11	1, 2, 3	
964-11	10, 15, 20, 25, 27, 30, 40	
966-11	3, 4, 5, 6	
1 967-21-10	1/4" Hex Quick Bit Holder	
1 969-2-21	Adapter, 50mm	
14 16121-11	1/4" Sockets, 6-Point 3.2, 4, 4.5, 5, 5.5, 6, 7, 8 9, 10, 11, 12, 13, 14mm	
1 16122-04	1/4" Ratchet Handle, 36T	
2 16123-02	1/4" Extension Bars, 55, 150mm	
1 16125-01	1/4" Universal Joint, 40mm	
1 16125-06	Coupler, 1/4"x1/4"	
1 S119-9	1/4" Interchangeable Screwdriver	989g

# HAND SOCKET SETS

## 1612-1620

Ratchet T Handle Set, 20pcs **1/4" 72T**



Series	Contents	Weight
7 16121-31	1/4" Torqs Sockets E4, E5, E6, E7, E8, E10, E11	738g
1 16122-13	1/4" Ratchet T Handle, 72T	
2 16123-02	1/4" Extension Bars, 100, 150mm	
1 16125-01	1/4" Universal Joint, 40mm	
9 16127-41	1/4" Bit Sockets, TX, 32mm ⊕ 8, 9, 10, 15, 20, 25, 27, 30, 40	

## 1612-1732S

Ratchet T Handle Set, 32pcs **1/4" 72T**



Series	Contents	Weight
20	1/4" Bits, 25mm	1.32kg
961-11	⊖ 4, 6.5	
962-11	⊕ 1, 2, 3	
963-11	⊕ 1, 2	
964-11	⊕ 10, 15, 20, 25, 27, 30, 40	
966-11	● 3, 4, 5, 6, 8, 10	
7 16121-11	1/4" Sockets, 6-Point 8, 9, 10, 11, 12, 13, 14mm	
1 16122-13	1/4" Ratchet T Handle, 72T	
2 16123-02	1/4" Extension Bars, 100, 150mm	
1 16125-01	1/4" Universal Joint, 40mm	
1 16125-06	Coupler, 1/4"x1/4"	

## 1612-3004

Magnetic Tool set, 4pcs

- 1/4"Dr socket-7~14mm
- 3/8"Dr socket-6~8mm
- 3/8"Dr socket-9~22mm
- 1/2"Dr socket-10~23mm
- 1/2"Dr socket-24~34mm



Series	Contents	Weight
1 967-23-6	Multi-Purpose Magnetizer	45g
3	Magnetizer Socket Wrench Inserts 1/4", 3/8", 1/2"	

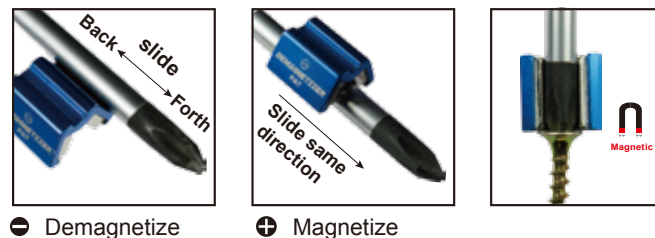
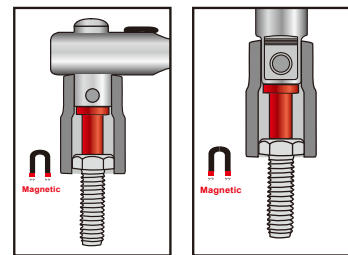
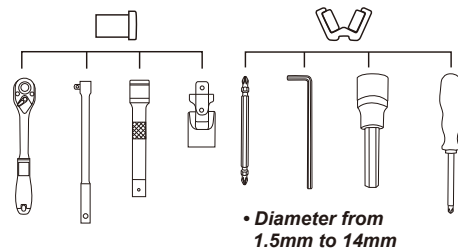

⊖ Demagnetize    ⊕ Magnetize



## 1612-0633S

Socket Sets, 33pcs **1/4" 36T**



Series	Contents	Weight
12 16121-11	1/4" Sockets, 6-Point 4, 4.5, 5, 5.5, 6, 7, 8, 9, 10, 11, 12, 13mm	1.12kg
1 16122-04	1/4" Ratchet Handle, 36T	
2 16123-02	1/4" Extension Bars, 55, 100mm	
1 16124-01	1/4" Sliding T Bar, 115mm	
1 16124-04	1/4" Spinner Handle, 145mm	
1 16125-01	1/4" Universal Joint, 40mm	
12 16127-11	1/4" Bit Sockets, 32mm ⊖ 3, 4, 5.5, 6.5, 8	
16127-21	⊕ 1, 2	
16127-61	● 3, 4, 5, 6, 8	
3 1586-3	Short Hex Key Wrenches, 1.5, 2.0, 2.5mm	

## 1612-2116S

Socket Sets, 16pcs **1/4" 36T**



Series	Contents	Weight
11 16121-11	1/4" Sockets, 6-Point 4, 4.5, 5, 5.5, 6, 7, 8, 9, 10, 11, 13mm	820g
1 16122-04	1/4" Ratchet Handle, 36T	
2 16123-02	1/4" Extension Bars, 55, 150mm	
1 16124-01	1/4" Sliding T Bar, 115mm	
1 16125-01	1/4" Universal Joint, 40mm	

## 1612-2226S

Socket Sets, 26pcs **1/4" 36T**



Series	Contents	Weight
12 16121-11	1/4" Sockets, 6-Point 4, 4.5, 5, 5.5, 6, 7, 8, 9, 10, 11, 12, 13mm	1.42kg
9 16121-12	1/4" Deep Sockets, 6-Point 5, 6, 7, 8, 9, 10, 11, 12, 13mm	
1 16122-04	1/4" Ratchet Handle, 36T	
2 16123-02	1/4" Extension Bars, 55, 150mm	
1 16124-04	1/4" Spinner Handle, 145mm	
1 16125-01	1/4" Universal Joint, 40mm	

## 1612-2333S

Socket Sets, 33pcs **1/4" 36T**



Series	Contents	Weight
13 16121-11	1/4" Sockets, 6-Point 4, 4.5, 5, 5.5, 6, 7, 8, 9, 10, 11, 12, 13, 14mm	1.4kg
1 16122-04	1/4" Ratchet Handle, 36T	
2 16123-02	1/4" Extension Bars, 55, 150mm	
1 16124-01	1/4" Sliding T Bar, 115mm	
1 16124-04	1/4" Spinner Handle, 145mm	
1 16125-01	1/4" Universal Joint, 40mm	
1 16125-06	Coupler, 1/4"x1/4"	
13	1/4" Bit Sockets, 32mm	
16127-11	⊖ 4, 5.5, 6.5	
16127-21	⊕ 1, 2, 3	
16127-31	⊕ 1, 2	
16127-61	● 3, 4, 5, 6, 7	

# HAND SOCKET SETS

## 1612-2443S

Socket Sets, 43pcs **1/4" 36T**



Series	Contents	Weight
13 16121-11	1/4" Sockets, 6-Point 4, 4.5, 5, 5.5, 6, 7, 8, 9, 10, 11, 12, 13, 14mm	⚖️:1.28kg
1 16122-04	1/4" Ratchet Handle, 36T	
2 16123-02	1/4" Extension Bars, 55, 150mm	
1 16124-04	1/4" Spinner Handle, 145mm	
1 16125-06	Coupler, 1/4"x1/4"	
22	1/4" Bits, 25mm	
961-11	⊖ 4, 5.5, 6.5, 8	
962-11	⊕ 1, 2, 3	
963-11	⊕ 1, 2, 3	
964-11	⊕ 10, 15, 20, 25, 27, 30, 40	
966-11	● 3, 4, 5, 6, 7	
3 1586-3	Short Hex Key Wrenches, 1.5, 2, 2.5mm	

## 1612-SK01S

Socket and Tool Set, 43pcs **1/4" 36T**



Series	Contents	Weight
12 16121-11	1/4" Sockets, 6-Point 4, 5, 5.5, 6, 7, 8, 9, 10, 11, 12, 13, 14mm	⚖️:2.05kg
12 16121-12	1/4" Deep Sockets, 6-Point 4, 5, 5.5, 6, 7, 8, 9, 10, 11, 12, 13, 14mm	
1 16122-04	1/4" Ratchet Handle, 36T	
1 16123-02	1/4" Extension Bars, 55mm	
1 16124-01	1/4" Sliding T Bar, 115mm	
1 16124-04	1/4" Spinner Handle, 145mm	
1 16125-01	1/4" Universal Joint, 40mm	
1 16125-04	3/8" x 1/4" Adapter	
12	1/4" Bit Sockets, 32mm	
16127-11	⊖ 3.5, 5.5, 8.0	
16127-21	⊕ 1, 2	
16127-31	⊕ 1, 2	
16127-61	● 3, 4, 5, 6, 8	
1 1739-21	1/4" Speedy Extension Bar, 150mm	

## 1613-SK03S

Socket Set, 24pcs **3/8" 36T**



Series	Contents	Weight
17 16131-11	3/8" Sockets, 6-Point 6, 7, 8, 9, 10, 11, 12, 13, 14, 15, 16, 17, 18, 19, 20, 21, 22mm	⚖️:2.57kg
1 16132-02	3/8" Ratchet Handle, 36T	
2 16133-02	3/8" Extension Bars, 75, 150mm	
1 16134-01	3/8" Sliding T Bar, 165mm	
1 16135-01	3/8" Universal Joint, 55mm	
2 16138-1	3/8" Spark Plug Sockets, 16, 21mm	

## 1613-SK04S

Socket Set, 26pcs **3/8" 36T**



Series	Contents	Weight
16 16131-11	3/8" Sockets, 6-Point 6, 7, 8, 9, 10, 11, 12, 13, 14, 15, 16, 17, 18, 19, 21, 22mm	⚖️:2.65kg
1 16132-02	3/8" Ratchet Handle, 36T	
2 16133-02	3/8" Extension Bars, 150, 230mm	
1 16134-01	3/8" Sliding T Bar, 200mm	
1 16135-01	3/8" Universal Joint, 55mm	
5 16137-61	3/8" Bit Sockets, 48mm ● 4, 5, 6, 8, 10mm	

## 1614-SK06

Accessory Set, 6pcs **1/2" 36T**



Series	Contents	Weight
1 16142-02	1/2" Ratchet Handle, 36T	⚖️:2.85kg
3 16143-02	1/2" Extension Bars, 50, 125, 250mm	
1 16144-01	1/2" Sliding T Bar, 250mm	
1 16145-02	1/2" Universal Joint, 78mm	

## 1614-SK09S

Socket Set, 22pcs **1/2"**



Series	Contents	Weight
22 16141-11	8, 10, 11, 12, 13, 14, 15, 16, 17, 18, 19, 20, 21, 22, 23, 24, 26, 27, 28, 30, 32, 34mm	⚖️:3.15kg

## 1614-3424S

Socket Set, 24pcs **1/2" 36T**



Series	Contents	Weight
18 16141-11	1/2" Sockets, 6-Point 10, 11, 12, 13, 14, 15, 16, 17, 18, 19, 20, 21, 22, 23, 24, 27, 30, 32mm	⚖️:5.5kg
1 16142-02	1/2" Ratchet Handle, 36T	
2 16143-02	1/2" Extension Bars, 125, 250mm	
1 16144-01	1/2" Sliding T Bar, 300mm	
1 16145-02	1/2" Universal Joint, 78mm	
1 16144-04	1/2" Speedy Driver, 395mm	

## 1614-4925S

Socket Sets, 25pcs **1/2" 36T**



Series	Contents	Weight
18 16141-11	1/2" Sockets, 6-Point 8, 9, 10, 11, 12, 13, 14, 15, 16, 17, 18, 19, 21, 22, 24, 27, 30, 32mm	⚖️:4.98kg
1 16142-02	1/2" Ratchet Handle, 36T	
2 16143-02	1/2" Extension Bars, 125, 250mm	
1 16144-01	1/2" Sliding T Bar, 300mm	
1 16145-02	1/2" Universal Joint, 78mm	
2 16148-1	1/2" Spark Plug Sockets, 16, 21mm	



# HAND SOCKET SETS

## 1614-SK10

Torks Socket, Wrench and Bit Set, 49pcs

1/4" 3/8" 1/2"

36T



Series	Contents	Weight
11 964-11	1/4" Bits, 25mm	2.45kg
	⊕ 6, 7, 8, 9, 10, 15, 20, 25, 27, 30, 40	
1 964-22	1/4" Bits, 70mm	
	⊕ 25	
1 969-2-11	1/4" Adapter, 25mm	
4 1243-5	Double Ring Torks Wrenches 6x8, 10x12, 14x18, 20x24mm	
11 1584-3	Short Torks Key Wrenches	
	⊕ 6, 7, 8, 9, 10, 15, 20, 25, 27, 30, 40mm	
5 16121-31	1/4" Torks Sockets, E4, E5, E6, E7, E8	
1 16122-14	1/4" Hex Ratchet Handle, 36T	
1 16125-06	Coupler, 1/4"x1/4"	
4 16131-31	3/8" Torks Sockets, E10, E11, E12, E14	
1 16135-06	Coupler, 5/16"x3/8"	
2 16137-41	3/8" Bits Sockets, 48mm	
	⊕ 40, 45	
4 16141-31	1/2" Torks Sockets, E16, E18, E20, E24	
3 16147-41	1/2" Bit Sockets, 55mm	
	⊕ 50, 55, 60	

## 1614-SK12S

Socket Sets, 14pcs 1/2" 36T



Series	Contents	Weight
11 16141-11	1/2" Sockets, 6-Point 10, 11, 12, 13, 14, 15, 17, 19, 21, 22, 24mm	2.9kg
1 16142-02	1/2" Ratchet Handle, 36T	
1 16143-02	1/2" Extension Bar, 125mm	
1 16144-01	1/2" Sliding T Bar, 300mm	

## 1614-SK13S

Socket Sets, 19pcs 1/2" 36T



Series	Contents	Weight
14 16141-11	1/2" Sockets, 6-Point 10, 11, 12, 13, 14, 15, 17, 19, 21, 22, 24, 27, 30, 32mm	4.05kg
1 16142-02	1/2" Ratchet Handle, 36T	
2 16143-02	1/2" Extension Bars, 125, 250mm	
1 16144-01	1/2" Sliding T Bar, 300mm	
1 16145-02	1/2" Universal Joint, 78mm	

## 1614-SK51

Bit Socket Set, 13pcs 1/2"



Series	Contents	Weight
9 16147-61	1/2" Bit Sockets, 55mm ⊕ 5, 6, 7, 8, 10, 12, 14, 17, 19	2.46kg
4 16147-61	1/2" Bit Sockets, 140mm ⊕ 6, 7, 8, 10	

## 1614-SK52

Bit Socket Set, 13pcs 1/2"



Series	Contents	Weight
13 16147-41	⊕ 40x100, 45x100, 55x140, 70x140	2.74kg
16147-61	⊕ 5x180, 6x100, 7x100, 8x100, 10x140	
16147-81	⊕ 6x100, 8x100, 10x100, 12x140	

## 1614-SK53

Bit Socket Set, 25pcs 1/2"



Series	Contents	Weight
25 16147-41	⊕ 20, 25, 27, 30, 40, 45, 50, 55, 60	3.34kg
16147-61	⊕ 5, 6, 7, 8, 9, 12, 14, 17, 19	
16147-81	⊕ 5, 6, 8, 10, 12, 14, 16	

## 1616-0506

Adapter Set, 6pcs

1/4" 3/8" 1/2" 3/4"



Series	Contents	Weight
1 16125-07	3/8" x 1/4" □	654g
2 16135-08	1/4" x 3/8" □, 1/2" x 3/8" □	
2 16145-06	3/8" x 1/2" □, 3/4" x 1/2" □	
1 16165-03	1/2" x 3/4" □	



## 1616-0221

Socket, 12-Point Set, 21pcs 3/4" 24T

Series	Contents	Weight
16 16161-41	3/4" Sockets, 12-Point 19, 21, 22, 23, 24, 26, 27, 29, 30, 32, 35, 36, 38, 41, 46, 50mm	15kg
1 16162-03	3/4" Ratchet Handle, 24 teeth, Push Release	
3 16163-01	3/4" Extension Bars, 100, 200, 400mm	
1 16164-01	3/4" Sliding T Bar, 460mm	

## 1616-0414

Socket, 6-Point Set, 14pcs 3/4" 24T

Series	Contents	Weight
10 16161-11	3/4" Sockets, 6-Point 22, 24, 27, 30, 32, 36, 38, 41, 46, 50mm	12.5kg
1 16162-03	3/4" Ratchet Handle, 24 teeth, Push Release	
2 16163-01	3/4" Extension Bars, 100, 200mm	
1 16164-01	3/4" Sliding T Bar, 460mm	

## 1618-0114

Socket, 6-Point Set, 14pcs 1" 24T

Series	Contents	Weight
10 16181-11	1" Sockets, 6-Point 36, 41, 46, 50, 55, 60, 65, 70, 75, 80mm	15.5kg
1 16182-01	1" Ratchet Handle, 24 teeth	
2 16183-01	1" Extension Bars, 200, 400mm	
1 16184-01	1" Sliding T Bar, 550mm	



TEAM SPONSORSHIP SUPER GT300-JAPAN

# HAND SOCKET SETS



## 1612-2545S

Socket Sets, 45pcs  $\frac{1}{4}$ " 36T



Series	Contents	Weight: 1.34kg
13 16121-11	1/4" Sockets, 6-Point 4, 4.5, 5, 5.5, 6, 7, 8, 9, 10, 11, 12, 13, 14mm	
7 16121-31	1/4" Torqs Socket, 25mm E4, E5, E6, E7, E8, E10, E11	
1 16122-04	1/4" Ratchet Handle, 36T	
2 16123-02	1/4" Extension Bars, 55, 150mm	
1 16124-01	1/4" Sliding T Bar, 115mm	
1 16124-04	1/4" Spinner Handle, 145mm	
1 16125-01	1/4" Universal Joint, 40mm	
19 16127-11	⊖ 4, 5.5, 6.5	
16127-21	⊕ 1, 2, 3	
16127-41	⊕ 8, 10, 15, 20, 25, 27, 30, 40	
16127-61	● 3, 4, 5, 6, 7	

## 1614-5027

Socket and Tool Sets, 27pcs  $\frac{1}{2}$ " 36T



Series	Contents	Weight: 4.11kg
8 16141-31	1/2" Torqs Sockets, 38mm E10, E11, E12, E14, E16, E18, E20, E24	
1 16142-02	1/2" Ratchet Handle, 36T	
2 16143-02	1/2" Extension Bars, 125, 250mm	
1 16145-02	1/2" Universal Joint, 78mm	
9 16147-41	1/2" Bit Sockets, TX, 55mm ⊕ 20, 25, 27, 30, 40, 45, 50, 55, 60	
6 1243-5	Double Ring Torqs Wrenches E6×E8, E7×E11, E10×E12, E14×E18 E16×E22, E20×E24	

## 1614-5140S

Socket Sets, 40pcs  $\frac{1}{2}$ " 36T



Series	Contents	Weight: 6.28kg
18 16141-11	1/2" Sockets, 6-Point 8, 9, 10, 11, 12, 13, 14, 15, 16, 17, 18 19, 21, 22, 24, 27, 30, 32mm	
1 16142-02	1/2" Ratchet Handle, 36T	
2 16143-02	1/2" Extension Bars, 125, 250mm	
1 16144-01	1/2" Sliding T Bar, 300mm	
1 16145-02	1/2" Universal Joint, 78mm	
11 16147-61	1/2" Bit Sockets, HX, 55mm ● 4, 5, 6, 7, 8, 9, 10, 12, 14, 17, 19mm	
6 16147-61	1/2" Bit Sockets, HX, 100mm ● 5, 6, 7, 8, 10, 12mm	

## 1614-5262S

Socket Sets, 63pcs  $\frac{1}{4}$ "  $\frac{1}{2}$ " 36T



Series	Contents	Weight: 4.7kg
12 16121-11	1/4" Sockets, 6-Point 4, 4.5, 5, 5.5, 6, 7, 8, 9, 10, 11, 12, 13mm	
1 16122-04	1/4" Ratchet Handle, 36T	
2 16123-02	1/4" Extension Bars, 55, 100mm	
1 16123-04	1/4" Flexible Extension Bar, 150mm	
1 16124-01	1/4" Sliding T Bar, 115mm	
1 16124-04	1/4" Spinner Handle, 145mm	
1 16125-01	1/4" Universal Joint, 40mm	
1 16125-06	Coupler, 1/4"x1/4"	
1 16135-05	3/8" 3-Way Adapter, 1/2" $\square$ x 3/8" $\square$	
16 16141-11	1/2" Sockets, 6-Point 10, 11, 12, 13, 14, 15, 16, 17, 18, 19, 21, 22 24, 27, 30, 32mm	
1 16142-02	1/2" Ratchet Handle, 36T	
2 16143-02	1/2" Extension Bars, 125, 250mm	
1 16145-02	1/2" Universal Joint, 78mm	
22 961-11	⊖ 4.0, 5.5, 6.5, 8.0	
962-11	⊕ 1, 2, 3	
963-11	⊕ 1, 2, 3	
965-11	⊕ 10, 15, 20, 25, 27, 30, 40	
966-11	● 3, 4, 5, 6, 7	



TEAM SPONSORSHIP SUPER GT300-JAPAN

## 1614-5397S

Socket and Tool Set, 97pcs  $\frac{1}{4}$ "  $\frac{1}{2}$ " 36T



Series	Contents	Weight: 5.77kg
12 16121-11	1/4" Sockets, 6-Point 4, 4.5, 5, 5.5, 6, 7, 8, 9, 10, 11, 12, 13mm	
5 16121-31	1/4" Torqs Sockets, 25mm E4, E5, E6, E7, E8	
1 16122-04	1/4" Ratchet Handle, 36T	
2 16123-02	1/4" Extension Bars, 55, 100mm	
1 16124-01	1/4" Sliding T Bar, 115mm	
1 16124-04	1/4" Spinner Handle, 145mm	
1 16125-01	1/4" Universal Joint, 40mm	
1 16125-06	Coupler, 1/4"x1/4"	
1 16135-05	3/8" 3-Way Adapter, 1/2" $\square$ x 3/8" $\square$	
17 16141-11	1/2" Sockets, 6-Point 10, 11, 12, 13, 14, 15, 16, 17, 18, 19, 20, 21, 22, 24 27, 30, 32mm	
8 16141-31	1/2" Torqs Sockets, 38mm E10, E11, E12, E14, E16, E18, E20, E24	
1 16142-02	1/2" Ratchet Handle, 36T	
2 16142-11	1/2" Swivel Handle, 380mm	
1 16143-02	1/2" Extension Bars, 125, 250mm	
1 16145-02	1/2" Universal Joint, 78mm	
2 16148-1	1/2" Spark Plug Sockets, 16, 21mm	
22 961-11	⊖ 4.0, 5.5, 6.5	
962-11	⊕ 1, 2, 3	
963-11	⊕ 1, 2, 3	
965-11	⊕ 10, 15, 20, 25, 27, 30, 40	
966-11	● 3, 4, 5, 6, 7, 8	
4 1711-7	Screwdriver ⊖ 6.5x25	
S111-3	⊖ 6.5x125	
1712-6	⊕ 2x25	
S112-3	⊕ 2x100	
10 1242-1	Combination Wrenches 8, 10, 11, 12, 13, 14, 15, 17, 19, 22mm	
1 15601-321	Combination Pliers, 180mm	
1 15604-12	Diagonal Cutting Nipper, 160mm	
1 15608-02	Water Pump Pliers, 250mm	
1 1383-81	Engineer's Hammer, 300g	

# HAND SOCKET SETS

## 1614-5495S

Socket Sets, 95pcs  $\frac{1}{4}$ "  $\frac{1}{2}$ " 36T



Series	Contents	Weight: 6.4kg
13 16121-11	1/4" Sockets, 6-Point 4, 4.5, 5, 5.5, 6, 7, 8, 9, 10, 11, 12, 13, 14mm	
8 16121-12	1/4" Deep Sockets, 6-Point, 50mm 6, 7, 8, 9, 10, 11, 12, 13mm	
1 16122-04	1/4" Ratchet Handle, 36T	
2 16123-02	1/4" Extension Bars, 55, 100mm	
1 16123-04	1/4" Flexible Extension Bar, 150mm	
1 16124-04	1/4" Spinner Handle, 145mm	
1 16125-01	1/4" Universal Joint, 40mm	
1 16125-06	Coupler, 1/4"x1/4"	
17	1/4" Bit Socket, 32mm	
16127-11	⊖ 4.0, 5.5, 6.5	
16127-21	⊕ 1, 2	
16127-31	⊕ 1, 2	
16127-41	⊗ 8, 10, 15, 20, 25, 30	
16127-61	● 3, 4, 5, 6	
1 16135-05	3/8" 3-Way Adapter, 1/2" $\square$ x 3/8" $\square$	
16	5/16" Bit, 30mm	
16136-11	⊖ 8, 10, 12	
16136-21	⊕ 3, 4	
16136-31	⊕ 3, 4	
16136-41	⊗ 40, 45, 50, 55	
16136-61	● 7, 8, 10, 12, 14	
17 16141-11	1/2" Sockets, 6-Point 10, 11, 12, 13, 14, 15, 16, 17, 18, 19, 20, 21, 22, 24, 27, 30, 32mm	
5 16141-12	1/2" Deep Sockets, 6-Point, 77mm 14, 15, 17, 19, 22mm	
1 16142-02	1/2" Ratchet Handle, 36T	
2 16143-02	1/2" Extension Bars, 125, 250mm	
1 16145-02	1/2" Universal Joint, 78mm	
1 16145-05	Coupler, 5/16"x1/2"	
2 16148-1	1/2" Spark Plug Sockets, 16, 21mm	
1 15409-11	Pick Up, 140-430mm	
3 1586-3	Short Hex Key Wrenches, 1.5, 2.0, 2.5mm	

## 1614-5584S

Socket and Tool Set, 84pcs  $\frac{1}{4}$ "  $\frac{1}{2}$ " 36T



Series	Contents	Weight: 6.05kg
13 16121-11	1/4" Sockets, 6-Point 4, 4.5, 5, 5.5, 6, 7, 8, 9, 10, 11, 12, 13, 14mm	
1 16122-04	1/4" Ratchet Handle, 36T	
2 16123-02	1/4" Extension Bars, 55, 100mm	
1 16123-04	1/4" Flexible Extension Bars, 150mm	
1 16124-01	1/4" Sliding T Bar, 115mm	
1 16124-04	1/4" Spinner Handle, 145mm	
1 16125-01	1/4" Universal Joint, 40mm	
1 16125-06	Coupler, 1/4"x1/4"	
17	1/4" Bit Socket, 32mm	
16127-11	⊖ 4.0, 5.5, 6.5	
16127-21	⊕ 1, 2	
16127-31	⊕ 1, 2	
16127-41	⊗ 8, 10, 15, 20, 25, 30	
16127-61	● 3, 4, 5, 6	
1 16135-05	3/8" 3-Way Adapter, 1/2" $\square$ x 3/8" $\square$	
16	5/16" Bit, 30mm	
16136-11	⊖ 8, 10, 12	
16136-21	⊕ 3, 4	
16136-31	⊕ 3, 4	
16136-41	⊗ 40, 45, 50, 55	
16136-61	● 7, 8, 10, 12, 14	
12 16141-11	1/2" Sockets, 6-Point 14, 15, 16, 17, 18, 19, 20, 22, 24, 27, 30, 32mm	
1 16142-02	1/2" Ratchet Handle, 36T	
2 16143-02	1/2" Extension Bars, 125, 250mm	
1 16145-02	1/2" Universal Joint, 78mm	
1 16145-05	Coupler, 5/16"x1/2"	
2 16148-1	1/2" Spark Plug Sockets, 16, 21mm	
1 15409-11	Pick Up, 140-430mm	
9 1242-1	Combination Wrenches 8, 10, 11, 12, 13, 14, 17, 19, 22mm	

## 1614-56101S

Socket and Tool Set, 101pcs  $\frac{1}{4}$ "  $\frac{1}{2}$ " 36T



Series	Contents	Weight: 8.66kg
12 16121-11	1/4" Sockets, 6-Point 4, 4.5, 5, 5.5, 6, 7, 8, 9, 10, 11, 12, 13mm	
6 16121-31	1/4" Torks Sockets, 25mm E4, E5, E6, E7, E8, E10	
1 16122-04	1/4" Ratchet Handle, 36T	
2 16123-02	1/4" Extension Bars, 75, 150mm	
1 16123-04	1/4" Flexible Extension Bar, 150mm	
1 16124-01	1/4" Sliding T Bar, 115mm	
1 16124-04	1/4" Spinner Handle, 145mm	
1 16125-01	1/4" Universal Joint, 40mm	
1 16125-06	Coupler, 1/4"x1/4"	
20 16141-11	1/2" Sockets, 6-Point 8, 9, 10, 11, 12, 13, 14, 15, 16, 17, 18, 19, 20, 21, 22, 23, 24, 27, 30, 32mm	
5 16141-31	1/2" Torks Sockets, 38mm E11, E12, E14, E16, E18	
1 16142-02	1/2" Ratchet Handle, 36T	
1 16143-01	1/2" Wobble Extension Bar, 50mm	
2 16143-02	1/2" Extension Bars, 125, 250mm	
1 16144-01	1/2" Sliding T Bar, 300mm	
1 16145-02	1/2" Universal Joint, 78mm	
2 16148-1	1/2" Spark Plug Sockets, 16, 21mm	
20	1/4" Bits, 25mm	
964-11	⊗ 8, 10, 15, 20, 25, 27, 30, 40, 45, 50	
966-11	● 3, 4, 5, 6, 7, 8, 10	
969-3-11	● 6, 8, 10	
11 1242-1	Combination Wrenches 8, 10, 11, 12, 13, 14, 15, 16, 17, 18, 19mm	
4 1245-51	Flare Nut Wrenches 8x10, 11x13, 12x14, 17x19mm	
1 1248-7	Adjustable Wrench, 203mm	
1 15601-321	Combination Pliers, 180mm	
4	Screwdriver	
S111-3	⊖ 5.5x125, 6.5x150	
S112-3	⊕ 1x80, 2x100	
1 U033-01	Telescope Mirror Stick and Magnetic Pick-Up	

## 1614-5787S

Socket and Tool Set, 87pcs  $\frac{1}{4}$ "  $\frac{1}{2}$ " 36T



Series	Contents	Weight: 7.41kg
10 16121-11	1/4" Sockets, 6-Point 4, 5, 6, 7, 8, 9, 10, 11, 12, 13mm	
1 16122-04	1/4" Ratchet Handle, 36T	
1 16123-02	1/4" Extension Bar, 100mm	
1 16124-04	1/4" Spinner Handle, 145mm	
1 16125-01	1/4" Universal Joint, 40mm	
1 16125-06	1/4" Coupler, 1/4"x1/4"	
11 16141-11	1/2" Sockets, 6-Point 10, 12, 13, 14, 15, 16, 17, 18, 19, 22, 24mm	
1 16142-02	1/2" Ratchet Handle, 36T	
1 16143-02	1/2" Extension Bars, 125mm	
22	1/4" Bits, 25mm	
961-11	⊖ 4.0, 5.5, 6.5	
962-11	⊕ 1, 2	
963-11	⊕ 1, 2, 3	
964-11	⊗ 10, 15, 20, 25, 27, 30, 40	
966-11	● 3, 4, 5, 6	
969-3-11	● 5, 6, 8	
6	Screwdriver	
S111-3	⊖ 4.0x100, 5.5x125, 6.5x150, 8.0x175	
S112-3	⊕ 1x80, 2x100	
11 1242-1	Combination Wrenches 8, 9, 10, 11, 12, 13, 14, 15, 17, 19, 22mm	
1 1383-81	Engineer's Hammer, 500g	
5 138-0305	Chisel Punches Set, 5pcs	
1 15602-211	Long Nose Pliers, 160mm	
1 15604-21	Heavy Duty Diagonal Cutting Nippers, 180mm	
1 15608-02	Water Pump Pliers, 250mm	
9 1586-3	Short Hex Key Set, 9pcs(158-5509) ● 1.5, 2, 2.5, 3, 4, 5, 6, 8, 10	
1 C021-02	Mini Hacksaw, 270mm	
1 G018-09	5M Metric Tape Ruler	

# HAND SOCKET SETS

## 1614-58104S

Socket and Tool Sets, 104pcs  $\frac{1}{4}$ "  $\frac{1}{2}$ " 36T



Series	Contents	Weight
13 16121-11	1/4" Sockets, 6-Point 4, 4.5, 5, 5.5, 6, 7, 8, 9, 10, 11, 12, 13, 14mm	8.9kg
8 16121-12	1/4" Deep Sockets, 6-Point, 50mm 6, 7, 8, 9, 10, 11, 12, 13mm	
1 16122-04	1/4" Ratchet Handle, 36T	
1 16123-02	1/4" Extension Bar, 150mm	
1 16124-01	1/4" Sliding T Bar, 115mm	
1 16124-04	1/4" Spinner Handle, 145mm	
1 16125-01	1/4" Universal Joint, 40mm	
17 16127-11	1/4" Bit Sockets, 32mm ⊖ 4, 5.5, 6.5	
16127-21	⊕ 1, 2	
16127-31	⊕ 1, 2	
16127-41	⊕ 8, 10, 15, 20, 25, 30	
16127-61	⊕ 3, 4, 5, 6	
1 16135-05	3/8" 3-Way Adapter, 1/2" $\square$ x 3/8" $\square$	
15 16136-11	5/16" Bits ⊖ 8, 10, 12	
16136-21	⊕ 3, 4	
16136-31	⊕ 3, 4	
16136-41	⊕ 40, 45, 50, 55	
16136-61	⊕ 8, 10, 12, 14	
18 16141-11	1/2" Sockets, 6-Point 10, 11, 12, 13, 14, 15, 16, 17, 18, 19, 20, 21, 22, 23, 24, 27, 30, 32mm	
4 16141-12	1/2" Deep Sockets, 6-Point, 77mm 14, 15, 17, 19mm	
1 16142-02	1/2" Ratchet Handle, 36T	
2 16143-02	1/2" Extension Bars, 125, 250mm	
1 16145-02	1/2" Universal Joint, 78mm	
1 16145-05	Coupler, 1/2" x 5/16"	
2 16148-1	1/2" Spark Plug Sockets, 16, 21mm	
10 1242-1	Combination Wrenches 8, 9, 10, 11, 12, 13, 14, 15, 17, 19mm	
1 15601-321	Combination Pliers, 180mm	
1 15604-12	Diagonal Cutting Nipper, 160mm	
1 15608-02	Water Pump Pliers, 250mm	
3 1586-3	Short Hex Key Wrenches, 1.5, 2.0, 2.5mm	

## 1614-6809

Bit Socket, HX Set, 9pcs  $\frac{1}{2}$ "



Series	Contents	Weight
9 16147-61	1/2" Bit Sockets, HX, 55mm ● 5, 6, 7, 8, 9, 10, 12, 14, 17	1.17kg

## 1614-6909

Bit Socket, TX Set, 9pcs  $\frac{1}{2}$ "



Series	Contents	Weight
9 16147-41	1/2" Bit Sockets, TX, 55mm ⊕ 20, 25, 27, 30, 40, 45, 50, 55, 60	1.2kg

## 1614-7009

Bit Socket Set, 9pcs  $\frac{1}{2}$ "



Series	Contents	Weight
3 16147-21	1/2" Bit Sockets, PH, 55mm ⊕ 2, 3, 4	1.21kg
3 16147-41	1/2" Bit Sockets, TX, 55mm ⊕ 27, 30, 45	
3 16147-61	1/2" Bit Sockets, HX, 55mm ● 8, 10, 12	

## 1614-7109

Bit Socket, SP Set, 9pcs  $\frac{1}{2}$ "



Series	Contents	Weight
4 16147-81	1/2" Bit Sockets, SP, 55mm ● 5, 6, 8, 10	1.54kg
5 16147-81	1/2" Bit Sockets, SP, 100mm ● 8, 10, 12, 14, 16	

## 1614-7209

Bit Socket, TP (Ribe) Set, 9pcs  $\frac{1}{2}$ "



Series	Contents	Weight
9 16147-44	1/2" Bit Sockets, TP, 55mm ⊕ 5, 6, 7, 8, 9, 10, 12, 13, 14	1.18kg

## 1614-7309

Bit Socket Set, 9pcs  $\frac{1}{2}$ "



Series	Contents	Weight
5 16147-41	1/2" Bit Sockets, TX, 55mm ⊕ 25, 27, 30, 40, 45	1.17kg
4 16147-61	1/2" Bit Sockets, HX, 55mm ● 6, 8, 10, 12	

## 1614-7409

Bit Socket Set, 9pcs  $\frac{1}{2}$ "



Series	Contents	Weight
3 16147-21	1/2" Bit Sockets, PH, 55mm ⊕ 2, 3, 4	1.17kg
6 16147-41	1/2" Bit Sockets, TX, 55mm ⊕ 25, 27, 30, 40, 45, 50	

## 1614-7509

Bit Socket, TX Set, 9pcs  $\frac{1}{2}$ "



Series	Contents	Weight
9 16147-41	1/2" Bit Sockets, TX, 100mm ⊕ 20, 25, 27, 30, 40, 45, 50, 55, 60	1.6kg

## 1614-7609

Bit Socket, TP (Ribe) Set, 9pcs  $\frac{1}{2}$ "



Series	Contents	Weight
9 16147-44	1/2" Bit Sockets, TP, 100mm ⊕ 5, 6, 7, 8, 9, 10, 12, 13, 14	1.6kg



# HAND SOCKET SETS

## 1614-7709

Bit Socket, HX Set, 9pcs **1/2"**



Series	Contents	Weight: 1.55kg
9 16147-61	1/2" Bit Sockets, HX, 100mm ● 5, 6, 7, 8, 9, 10, 12, 14, 17	

## 1614-43147S

Socket Display Stand Set, 147pcs **1/2"**



Series	Contents	Weight: 20.35kg
147 16141-11	1/2" Sockets, 6-Point 10x11, 11x11, 12x11, 13x11, 14x11, 15x11 16x11, 17x10, 19x10, 22x8, 23x8, 24x8, 26x7, 27x7, 30x6, 32mmx6	

## D05-05113

Socket Set, 113pcs

• With Shelf And Display Board



Series	Contents
113 16141-11	8x7, 10x7, 11x7, 12x7, 13x7, 14x7, 15x7, 16x7, 17x6, 18x6, 19x6, 20x6, 21x6, 22x5, 23x5, 24x5, 27x4, 30x4, 32mmx4



# MULTI-FUNCTIONAL BANLIN SOCKETS (PAT.)



Multi-functional  
**ONE SOCKET CAN DO IT ALL!**



**Toughness**  
More than multifunctional,  
**+70% higher torque strength than DIN standard.**

## HIGH TORQUE WITH NO DAMAGE

These multi-lock and perfect fit wrenches and sockets are the latest in auto-repair innovative tools which can be used on all types of nuts and bolts. Whirpower's BANLIN design allows applications of high torque without damaging the fastener.

The round angled profiles provide increased resistance and protect the nuts against caulking. The bolts' point of contact are evenly distributed onto larger surface areas during application, thus distributing pressure instead of connecting to several sharp points. This results in torque distribution which limits damage to the bolt. This tool can still provide sufficient torque even when the nut is damaged beyond 50% of its original condition.

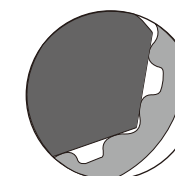

- Both, BANLIN sockets and wrenches, exert over 50% more torque than DIN standard requirements.
- Additional Imperial and metric dimensions marked onto the tool, for additional distribution and reading convenience.
- This BANLIN design has been patented worldwide.
- If these tools are used, both the tools and the bolts/nuts will have 50% longer lives than traditional tools used.

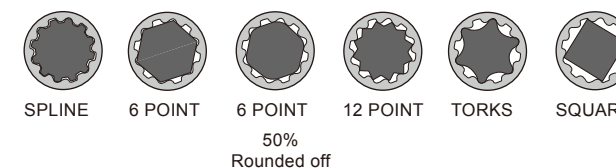

## ONE FOR ALL ALL IN ONE

SIZE	6	7	8	9	10	11	12	13	14	15	16	17	18
<b>Metric</b>	6mm	7mm	8mm	9mm	10mm	11mm	12mm	13mm	14mm	15mm	16mm	17mm	18mm
<b>Inch</b>		9/32"	5/16"	11/32"	3/8"	7/16"	15/32"	1/2"	9/16"	19/32"	5/8"	21/32"	11/16"
<b>E(torx)</b>	E8		E10	E11	E12	E14		E16	E18		E20		E22
SIZE	19	20	21	22	23	24	25	26	27	28	29	30	32
<b>Metric</b>	19mm	20mm	21mm	22mm	23mm	24mm	25mm	26mm	27mm	28mm	29mm	30mm	32mm
<b>Inch</b>	3/4"	25/32"	13/16"	7/8"	29/32"	15/16"	31/32"	1"	1-1/16"	1-3/32"	1-1/8"	1-3/16"	1-1/4"
<b>E(torx)</b>	E24		E26	E28	E28	E30	E32	E32	E34	E36	E36	E38	E40

# BANLIN SOCKETS AND ACCESSORIES

## 1638-1

### Banlin Combination Wrenches, 15° Offset Ring

- Chrome vanadium steel
- Mat chrome finish

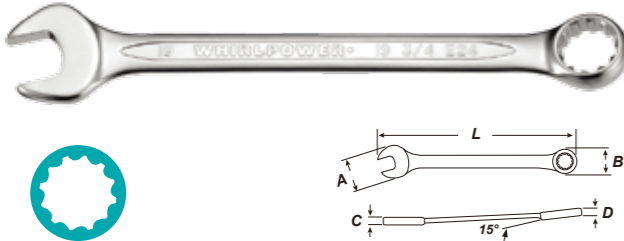

A mm	B mm / inch / TX	C mm	D mm	L mm	Code	g
6	6 E8	3	5	105	0606	21
7	7 9/32" E11	3	5	115	0707	23
8	8 5/16" E10	4	5	125	0808	26
9	9 11/32" E11	4	6	135	0909	29
10	10 3/8" E12	4	6	145	1010	39
11	11 7/16" E14	5	7	155	1111	52
12	12 15/32" E14	5	7	165	1212	64
13	13 1/2" E16	5	8	175	1313	68
14	14 9/16" E18	6	8	185	1414	87
15	15 19/32" E18	6	9	195	1515	102
16	16 5/8" E20	6	9	205	1616	114
17	17 21/32" E20	6	10	215	1717	135
18	18 11/16" E22	7	10	225	1818	154
19	19 3/4" E24	7	11	235	1919	178
20	20 25/32" E24	7	11	245	2020	192
21	21 13/16" E26	7	12	255	2121	216
22	22 7/8" E28	7	12	265	2222	237
23	23 29/32" E28	8	12	275	2323	282
24	24 15/16" E30	8	13	285	2424	309
25	25 31/32" E32	8	13	295	2525	314
26	26 1" E32	8	13	305	2626	344
27	27 1-1/16" E34	9	14	315	2727	369
28	28 1-3/32" E36	9	14	325	2828	412
29	29 1/8" E36	9	14	335	2929	441
30	30 1-3/16" E38	9	14	345	3030	493
32	32 1-1/4" E40	10	15	365	3232	464

### Banlin Combination Wrenches Set



Contents	Code	kg
8 8, 10, 12, 13, 14, 15, 17, 19mm	A08	0.69
14 10, 11, 12, 13, 14, 16, 17, 19, 21, 22, 24, 27, 30, 32mm	E14	2.96



Contents	Code	kg
13 8, 9, 10, 11, 12, 13, 14, 15, 16, 17, 18, 19, 22mm	H13	1.42

## 1638-3

### Banlin Double Ring Wrenches, 75° Offset Ring

- Chrome vanadium steel
- Mat chrome finish

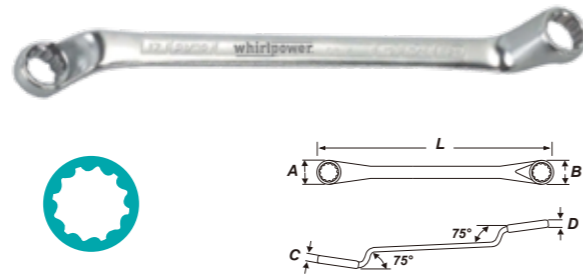

A mm / inch / TX	B mm / inch / TX	C mm	D mm	L mm	Code	g
6 E8	7 9/32"	6	6	168	0607	40
6 E8	8 5/16" E10	6	6	168	0608	44
8 5/16" E10	9 11/32" E11	7	7	183	0809	59
8 5/16" E10	10 3/8" E12	7	7	183	0810	60
10 3/8" E12	11 7/16" E14	8	9	198	1011	87
10 3/8" E12	12 15/32" E14	8	9	198	1012	87
11 7/16" E14	13 1/2" E16	9	10	217	1113	121
12 15/32" E14	13 1/2" E16	9	10	217	1213	120
12 15/32" E14	14 9/16" E18	9	10	217	1214	130
13 1/2" E16	14 9/16" E18	9	10	217	1314	138
13 1/2" E16	15 19/32" E18	10	10	239	1315	145
14 9/16" E18	15 19/32" E18	10	10	239	1415	157
14 9/16" E18	17 21/32" E20	10	11	260	1417	204
16 5/8" E20	17 21/32" E20	11	11	260	1617	205
17 21/32" E20	19 3/4" E24	11	12	292	1719	259
18 11/16" E22	19 3/4" E24	11	12	292	1819	271
19 3/4" E24	21 13/16" E26	12	13	318	1921	335
19 3/4" E24	22 7/8" E28	12	13	318	1922	367
20 25/32" E24	22 7/8" E28	12	13	318	2022	359
21 13/16" E26	23 29/32" E28	13	14	330	2123	409
22 7/8" E28	24 15/16" E30	13	14	330	2224	425
23 29/32" E28	26 1" E32	14	15	345	2326	468
24 15/16" E30	26 1" E32	14	15	345	2426	518
24 15/16" E30	27 1-1/16" E34	14	15	345	2427	520
25 31/32" E32	28 1-3/32" E36	14	15	355	2528	552
27 1-1/16" E34	29 1-1/8" E36	15	17	365	2729	610
27 1-1/16" E34	30 1-3/16" E38	15	17	365	2730	645
27 1-1/16" E34	32 1-1/4" E40	15	17	365	2732	655
30 1-3/16" E38	32 1-1/4" E40	16	17	370	3032	675

### Banlin Double Ring Wrenches Set



Contents	Code	kg
12 6x7, 8x9, 8x10, 10x11, 12x13, 14x15, 16x17, 18x19, 20x22, 21x23, 24x27, 30x32mm	B12	3.09

## 1632

### Banlin Socket 1/4"

- Chrome vanadium steel
- Mat chrome finish

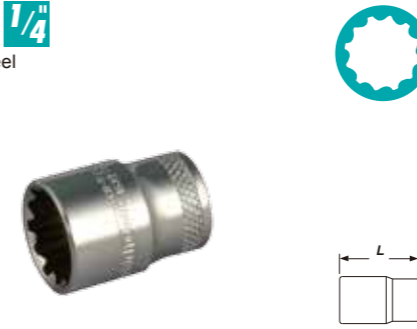

mm	Size Inch	TX	L mm	Code	g
3.2	1/8"	E4	25	032	12
4	5/32"	E5	25	040	12
4.5			25	045	12
5	3/16"	E6	25	050	12
5.5	7/32"	E7	25	055	13
6	1/4"	E8	25	060	13
		E8	25	0832	13
7	9/32"		25	070	13
8	5/16"	E10	25	080	13
9	11/32"	E11	25	090	17
10	3/8"	E12	25	100	19
11	7/16"	E14	25	110	21
12	15/32"		25	120	24
13	1/2"	E16	25	130	28
14	9/16"	E18	25	140	25

## 1633

### Banlin Socket 3/8"

- Chrome vanadium steel
- Mat chrome finish



mm	Size Inch	TX	L mm	Code	g
6		E8	28	060	23
	1/4"	E8	28	0832	23
7	9/32"		28	070	23
8	5/16"	E10	28	080	23
9	11/32"	E11	28	090	24
10	3/8"	E12	28	100	24
11	7/16"	E14	28	110	27
12	15/32"		28	120	28
13	1/2"	E16	28	130	29
14	9/16"	E18	28	140	29
15	19/32"		28	150	34
16	5/8"	E20	28	160	38
17	21/32"		30	170	50
18	11/16"	E22	30	180	54
19	3/4"	E24	30	190	61
20	25/32"		30	200	59
21	13/16"	E26	30	210	64
22	7/8"	E28	32	220	79
23	29/32"	E28	32	230	87
24	15/16"	E30	32	240	89

## 1634

### Banlin Socket 1/2"

- Chrome vanadium steel
- Mat chrome finish



mm	Size Inch	TX	L mm	Code	g
8	5/16"	E10	38	080	48
9	11/32"	E11	38	090	51
10	3/8"	E12	38	100	53
11	7/16"	E14	38	110	54
12	15/32"		38	120	55
13	1/2"	E16	38	130	56
14	9/16"	E18	38	140	59
15	19/32"		38	150	63
16	5/8"	E20	38	160	70
17	21/32"		38	170	74
18	11/16"	E22	38	180	75
19	3/4"	E24	38	190	70
20	25/32"		40	200	86
21	13/16"	E26	40	210	95
22	7/8"	E28	40	220	96
23	29/32"	E28	40	230	107
24	15/16"	E30	42	240	122
25	31/32"	E32	42	250	135
26	1"	E32	42	260	152
27	1-1/16"	E34	44	270	173
28	1-3/32"	E36	44	280	151
29	1-1/8"	E36	44	290	186
30	1-3/16"	E38	45	300	193
32	1-1/4"	E40	45	320	225

## 16338-1

### Banlin Spark Plug Socket 3/8"

- Chrome vanadium steel
- Mat chrome finish

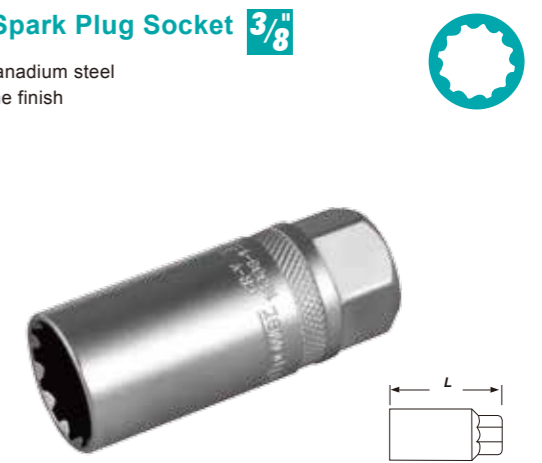

mm	Size Inch	TX	L mm	Code	g
16	5/8"	E20	65	16	86
21	13/16"	E26	67	21	130

# BANLIN SOCKETS AND ACCESSORIES

## 16348-1

### Banlin Spark Plug Socket 1/2"

- Chrome vanadium steel
- Mat chrome finish



mm	Size Inch	TX	L mm	Code	g
16	5/8"	E20	65	16	98
21	13/16"	E26	67	21	136



## 163-2314

### Banlin Speedy Extension Bar Set, 14pcs 1/4"

Series	Contents	g
12 1632	1/4" Banlin Sockets 4, 4.5, 5, 5.5, 6, 7, 8, 9, 10, 11, 12, 13mm	288g
1 16124-01	1/4" Sliding T Bar, 115mm	
1 1739-21	1/4" Speedy Extension Bars, 150mm	

## 163-2411

### Banlin Speedy Extension Bar Set, 11pcs 3/8"

Series	Contents	g
9 1633	3/8" Banlin Sockets 9, 10, 11, 12, 13, 14, 15, 17, 19mm	766g
1 16134-01	3/8" Sliding T Bar, 165mm	
1 1739-21	3/8" Speedy Extension Bar, 250mm	

## 163-2548

### Banlin Socket and Bit Set, 48pcs 1/4" 72T



Series	Contents	g
14 1632	1/4" Banlin Sockets 3.2, 4, 4.5, 5, 5.5, 6, 7, 8, 9, 10, 11, 12, 13, 14mm	961g
1 16122-17	1/4" Mini Ratchet Handle	
1 16123-02	1/4" Extension Bar, 55mm	
1 16124-01	1/4" Sliding T Bar, 115mm	
1 16125-01	1/4" Universal Joint, 40mm	
1 16125-06	Coupler, 1/4"x1/4"	
28	1/4" Bits, 25mm	
961-11	⊖ 4, 5.5, 6.5	
962-11	⊕ 1, 2x2, 3	
963-11	⊕ 1, 2, 3	
964-11	⊗ 10, 15, 20, 25, 27, 30, 40	
965-11	⊗ 10, 15, 20, 25, 27, 30, 40	
966-11	● 3, 4, 5, 6	
1 1739-21	1/4" Speedy Extension Bar, 150mm	

## 163-2625

### Banlin Socket and Bit Set, 25pcs 1/4" 72T



Series	Contents	g
6 1632	1/4" Banlin Sockets 4, 5, 6, 8, 10, 13mm	348g
1 16122-17	1/4" Mini Ratchet Handle	
1 16123-02	1/4" Extension Bar, 55mm	
1 16125-06	Adapter, 1/4"SQ. Driver 1/4"hex	
16	1/4" Bits, 25mm	
961-11	⊖ 4, 5.5, 6.5	
962-11	⊕ 1, 2	
963-11	⊕ 1, 2	
964-11	⊗ 10, 15, 20, 25, 30, 40	
966-11	● 4, 5, 6	

## 1632-2443

### Banlin Socket Sets, 43pcs 1/4" 36T



Series	Contents	g
13 1632	1/4" Banlin Sockets 4, 4.5, 5, 5.5, 6, 7, 8, 9, 10, 11, 12, 13, 14mm	1.4kg
1 16122-04	1/4" Ratchet Handle, 36T	
2 16123-02	1/4" Extension Bars, 55, 150mm	
1 16124-04	1/4" Spinner Handle, 145mm	
1 16125-06	Coupler, 1/4"x1/4"	
22	1/4" Bits, 25mm	
961-11	⊖ 4, 5.5, 6.5, 8	
962-11	⊕ 1, 2, 3	
963-11	⊕ 1, 2, 3	
964-11	⊗ 10, 15, 20, 25, 27, 30, 40	
966-11	● 3, 4, 5, 6, 7	
3 1586-3	Short Hex Key Wrenches, 1.5, 2, 2.5mm	

## 1634-SK13

### Banlin Socket Sets, 19pcs 1/2" 36T



Series	Contents	g
14 1634	1/2" Banlin Sockets 10, 11, 12, 13, 14, 15, 17, 19, 21, 22, 24, 27, 30, 32mm	3.04kg
1 16142-02	1/2" Ratchet Handle, 36T	
2 16143-02	1/2" Extension Bars, 125, 250mm	
1 16144-01	1/2" Sliding T Bar, 300mm	
1 16145-02	1/2" Universal Joint, 78mm	

## 1634-5262

### Banlin Socket Sets, 63pcs 1/4" 1/2" 36T



Series	Contents	g
12 1632	1/4" Banlin Sockets 4, 4.5, 5, 5.5, 6, 7, 8, 9, 10, 11, 12, 13mm	4.7kg
1 16122-04	1/4" Ratchet Handle, 36T	
2 16123-02	1/4" Extension Bars, 55, 100mm	
1 16123-04	1/4" Flexible Extension Bar, 150mm	
1 16124-01	1/4" Sliding T Bar, 115mm	
1 16124-04	1/4" Spinner Handle, 145mm	
1 16125-01	1/4" Universal Joint, 40mm	
1 16125-06	Coupler, 1/4"x1/4"	
1 16135-05	3/8" 3-Way Adapter, 1/2" □ × 3/8" □	
16 1634	1/2" Banlin Sockets 10, 11, 12, 13, 14, 15, 16, 17, 18, 19, 21, 22, 24, 27, 30, 32mm	
1 16142-02	1/2" Ratchet Handle, 36T	
2 16143-02	1/2" Extension Bars, 125, 250mm	
1 16145-02	1/2" Universal Joint, 78mm	
22	1/4" Bits, 25mm	
961-11	⊖ 4.0, 5.5, 6.5, 8.0	
962-11	⊕ 1, 2, 3	
963-11	⊕ 1, 2, 3	
965-11	⊗ 10, 15, 20, 25, 27, 30, 40	
966-11	● 3, 4, 5, 6, 7	



# T-WRENCH

## 1634-5584

Banlin Socket and Tool Set, 84pcs **1/4" 1/2" 36T**



Series	Contents	Weight: 6.05kg
13 1632	1/4" Banlin Sockets 4, 4.5, 5, 5.5, 6, 7, 8, 9, 10, 11, 12, 13, 14mm	
1 16122-04	1/4" Ratchet Handle, 36T	
2 16123-02	1/4" Extension Bars, 55, 100mm	
1 16123-04	1/4" Flexible Extension Bar, 150mm	
1 16124-01	1/4" Sliding T Bar, 115mm	
1 16124-04	1/4" Spinner Handle, 145mm	
1 16125-01	1/4" Universal Joint, 40mm	
1 16125-06	Coupler, 1/4"x1/4"	
17	1/4" Bit Sockets, 32mm	
16127-11	⊖ 4.0, 5.5, 6.5	
16127-21	⊕ 1, 2	
16127-31	⊕ 1, 2	
16127-41	⊗ 8, 10, 15, 20, 25, 30	
16127-61	● 3, 4, 5, 6	
1 16135-05	3/8" 3-Way Adapter, 1/2" x 3/8" □	
16	5/16" Bits, 30mm	
16136-11	⊖ 8, 10, 12	
16136-21	⊕ 3, 4	
16136-31	⊕ 3, 4	
16136-41	⊗ 40, 45, 50, 55	
16136-61	● 7, 8, 10, 12, 14	
12 1634	1/2" Banlin Sockets 14, 15, 16, 17, 18, 19, 20, 22, 24, 27, 30, 32mm	
1 16142-02	1/2" Ratchet Handle, 36T	
2 16143-02	1/2" Extension Bars, 125, 250mm	
1 16145-02	1/2" Universal Joint, 78mm	
1 16145-05	Coupler, 5/16"x1/2"	
2 16348-1	1/2" Banlin Spark Plug Sockets, 16, 21mm	
1 15409-11	Pick Up, 140-430mm	
9 1638-1	Banlin Combination Wrenches 8, 10, 11, 12, 13, 14, 17, 19, 22mm	

## 1634-58104

Banlin Socket And Tools, 104pcs **1/4" 1/2" 36T**



Series	Contents	Weight: 5.77kg
13 1632	1/4" Banlin Sockets 4, 4.5, 5, 5.5, 6, 7, 8, 9, 10, 11, 12, 13, 14mm	
8 16121-12	1/4" Deep Sockets, 6-Point, 50mm 6, 7, 8, 9, 10, 11, 12, 13mm	
1 16122-04	1/4" Ratchet Handle, 36T	
1 16123-02	1/4" Extension Bar, 150mm	
1 16124-01	1/4" Sliding T Bar, 115mm	
1 16124-04	1/4" Spinner Handle, 145mm	
1 16125-01	1/4" Universal Joint, 40mm	
17	1/4" Bit Sockets, 32mm	
16127-11	⊖ 4, 5.5, 6.5	
16127-21	⊕ 1, 2	
16127-31	⊕ 1, 2	
16127-41	⊗ 8, 10, 15, 20, 25, 30	
16127-61	● 3, 4, 5, 6	
1 16135-05	3/8" 3-Way Adapter, 1/2" x 3/8" □	
15	5/16" Bits, 30mm	
16136-11	⊖ 8, 10, 12	
16136-21	⊕ 3, 4	
16136-31	⊕ 3, 4	
16136-41	⊗ 40, 45, 50, 55	
16136-61	● 8, 10, 12, 14	
18 1634	1/2" Banlin Sockets 10, 11, 12, 13, 14, 15, 16, 17, 18, 19 20, 21, 22, 23, 24, 27, 30, 32mm	
4 16141-12	1/2" Deep Sockets, 6-Point, 77mm 14, 15, 17, 19mm	
1 16142-02	1/2" Ratchet Handle, 36T	
2 16143-02	1/2" Extension Bars, 125, 250mm	
1 16145-02	1/2" Universal Joint, 78mm	
1 16145-05	Coupler, 1/2"x5/16"	
2 16348-1	1/2" Banlin Spark Plug Sockets, 16, 21mm	
10 1638-1	Banlin Combination Wrenches 8, 9, 10, 11, 12, 13, 14, 15, 17, 19mm	
1 15601-321	Combination Pliers, 180mm	
1 15604-12	Diagonal Cutting Nipper, 160mm	
1 15608-02	Water Pump Pliers, 250mm	
3 1586-3	Short Hex Key Wrenches, 1.5, 2.0, 2.5mm	

## 1737-21-2

Speedy Quick Bit Holder **1/4"**

- PA6 plastic sleeve
- Blade: chrome vanadium steel
- Bit holder stainless steel
- Mat chrome finish



Size	L mm	Code	Weight g
1/4"	180	18014	105

## 1739-21

Speedy Extension Bar **1/4" 3/8" 1/2"**

- PA6 plastic sleeve
- Chrome vanadium steel
- Mat chrome finish



Size	L mm	Code	Weight g
1/4"	150	15014	70
1/4"	230	23014	108
3/8"	225	23038	224
3/8"	250	25038	240
1/2"	250	25012	448

## 1739-23

Speedy Extension Bar with Quick Release

- PA6 plastic sleeve
- Chrome vanadium steel
- Mat chrome finish

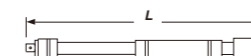

Size	L mm	Code	Weight g
3/8"	250	25038	250
1/2"	250	25012	455

## 17310-09

T Bend Driver

- Chrome vanadium steel
- Mat chrome finish

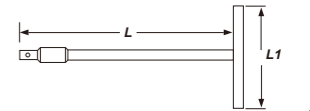

Size	L mm	L1 mm	Code	Weight g
1/4"	215	150	0832	150
3/8"	265	180	1232	340
1/2"	300	200	1632	450

## 17310-10

T Bend Deep Socket Wrench

- Chrome vanadium steel
- Mat chrome finish

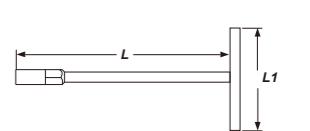
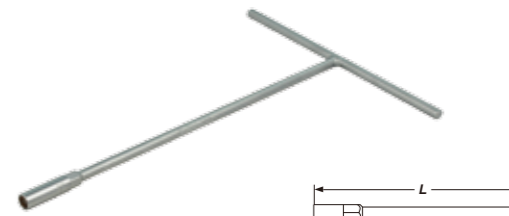

Size	L mm	L1 mm	Code	Weight g
8	300	200	080	200
9	300	200	090	200
10	300	200	100	310
11	300	200	110	310
12	300	200	120	310
13	300	250	130	420
14	300	250	140	420
17	300	250	170	550
19	300	250	190	550

**ОФИЦИАЛЬНЫЙ ДИЛЕР В УКРАИНЕ:**

[storgom.ua](http://storgom.ua)

**ГРАФИК РАБОТЫ:**

Пн. – Пт.: с 8:30 по 18:30

Сб.: с 09:00 по 16:00

Вс.: с 10:00 по 16:00

**КОНТАКТЫ:**

+38 (044) 360-46-77

+38 (066) 77-395-77

+38 (097) 77-236-77

+38 (093) 360-46-77

Детальное описание товара: <https://storgom.ua/product/nabor-bit-i-golovok-whirlpower-1634-5262-240-9.html>

Другие товары: <https://storgom.ua/nabory-instrumentov.html>